

T. 22 S. R. 8 W. W.M.

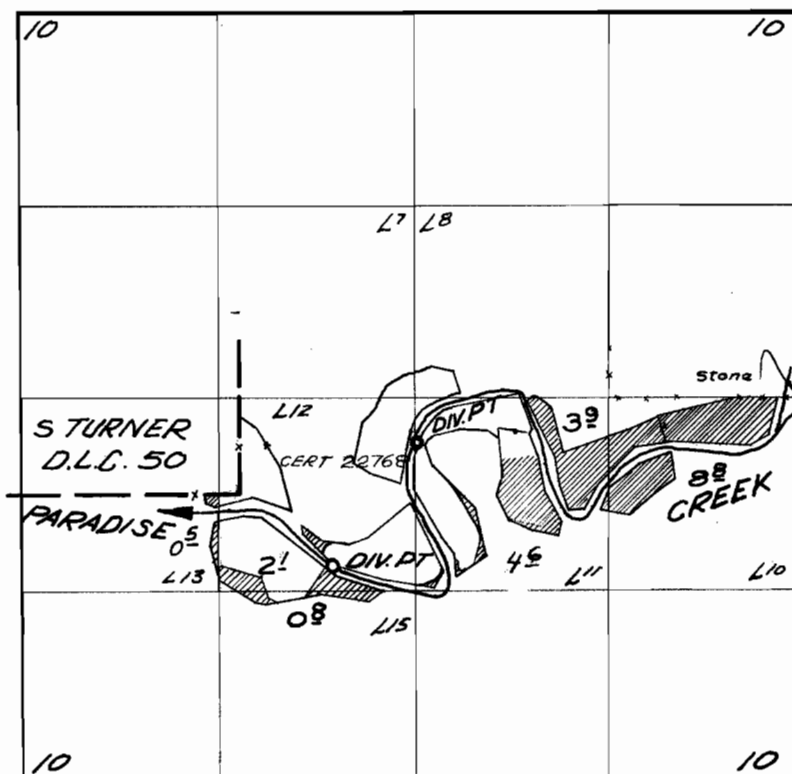

Div. Pts. located 3220 ft W & 1150 ft S and 2640 ft W & 290 ft. S. both from the E 1/4 cor of Section 10

FINAL PROOF SURVEY UNDER

Application No. 40994 Permit No. 30568
IN NAME OF

GEORGE M. DIPPREY

Surveyed May 19, 1966, by V. GARNER