

T.4S.R.1&2W.W.M.

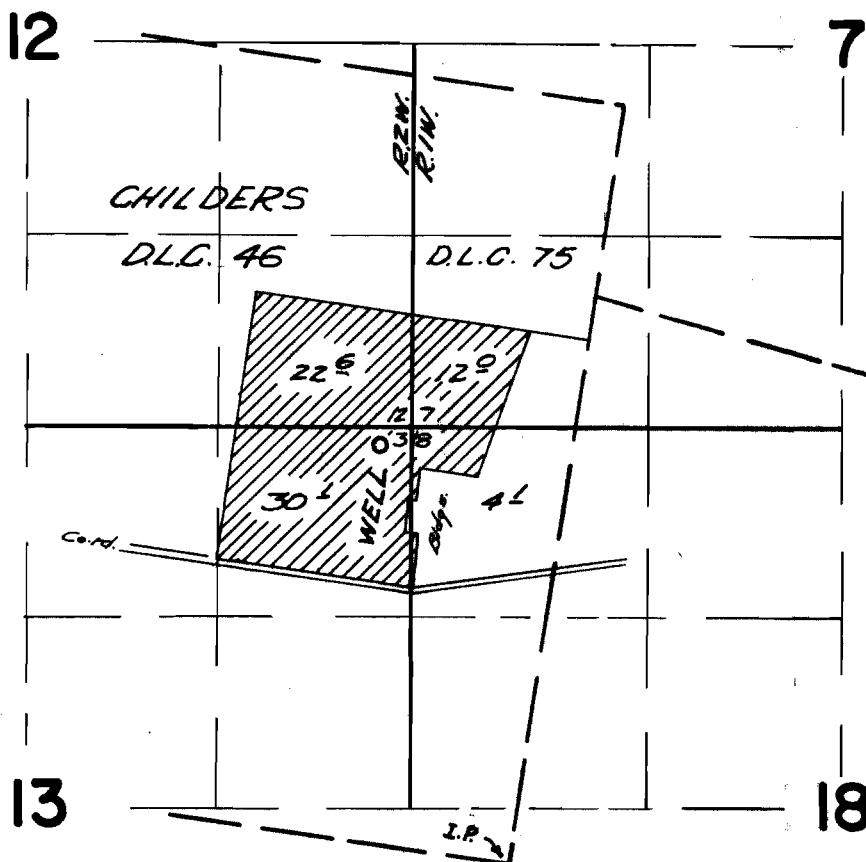

*Div. Pt. located 2880 ft. N. & 910 ft. W. from
the S.E. cor of Childers D.L.C. # 46*

FINAL PROOF SURVEY UNDER

Application No. *G-3105* Permit No. *G-2902*
IN NAME OF

H. R. DRIEVER

Surveyed *Oct. 20, 1966*, by *V. GARNER*