

# T.6N.R.35&36E.W.M.

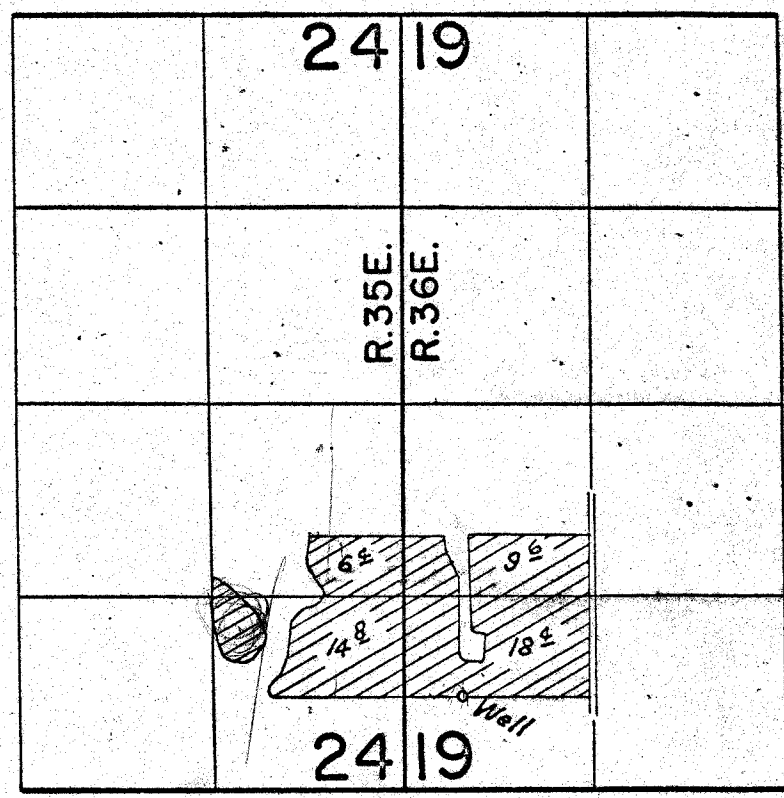

Well located 620 ft. N. and 880 ft. W. from the SE. cor S.W. 1/4 SW 1/4 Section 19

## FINAL PROOF SURVEY UNDER

Application No. G-210.6... Permit No. G-1936...  
IN NAME OF

**MARK McCOY**

Surveyed April 17, 1964, by B. Jackson.....