

T.6 N. R.35 E. W.M.

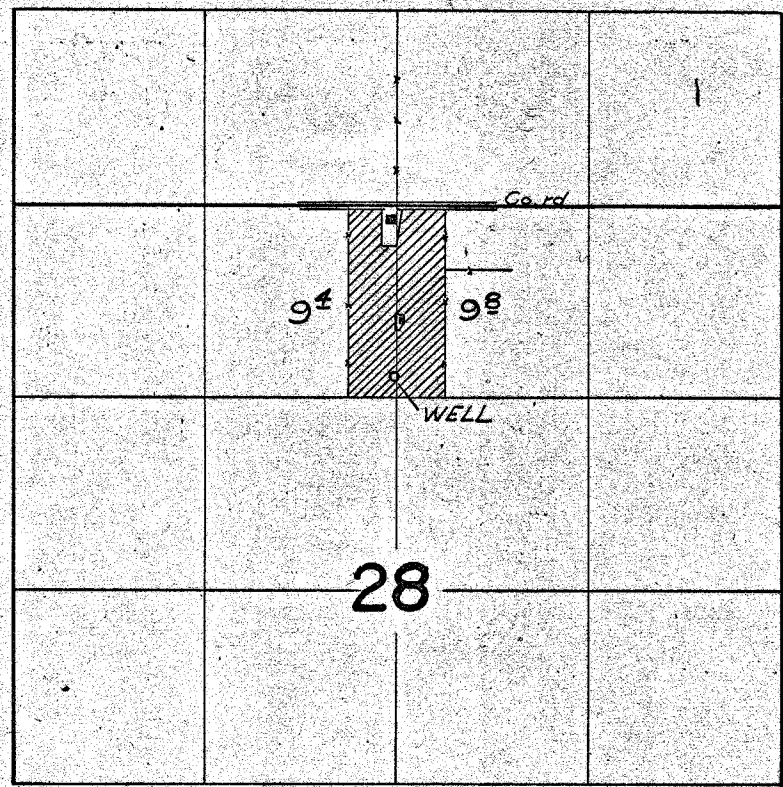

Well located 20 ft W. & 1180 ft S from
the N $\frac{1}{2}$ cor. of Section 28

FINAL PROOF SURVEY UNDER

Application No. G-2390. Permit No. G-2229.
IN NAME OF

HILDA SMILEY

Surveyed Oct. 26 1968, by V. GARNER...