

# T.3S. R.16E.W.M.

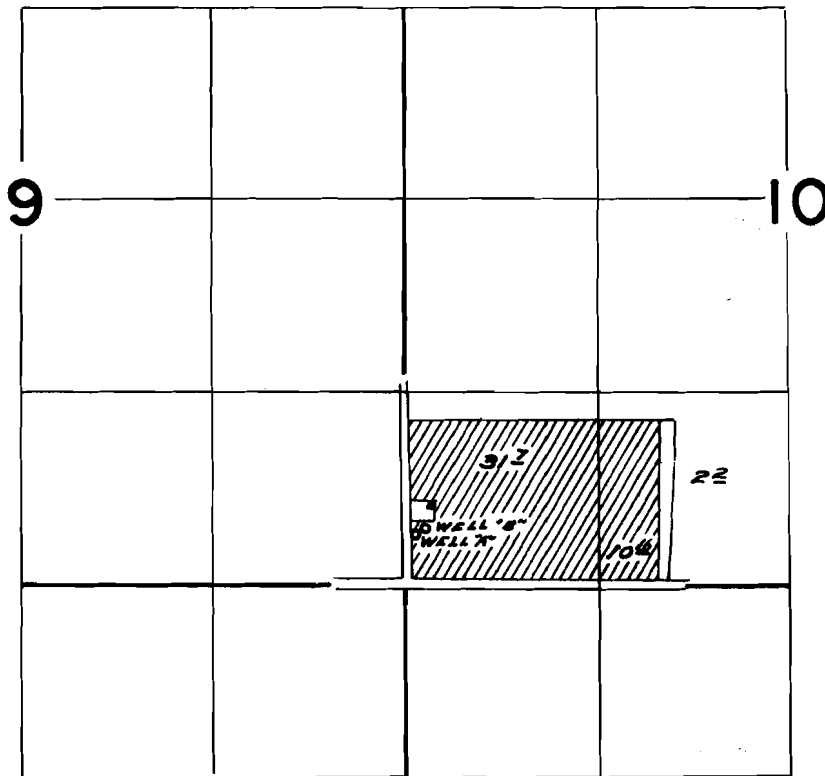

WELL "X" Located 330 ft. N. & 70 ft. E. both from SW. Cor. Sec. 10  
 WELL "B" Located 380 ft. N. & 140 ft. E.

## FINAL PROOF SURVEY UNDER

Application No. G-1879 Permit No. G-1735  
 IN NAME OF

E. J. & Elizabeth Hartley

Surveyed June 21 1966, by W. J. Ruppert

G1735