

T29S. R.4W. W.M.

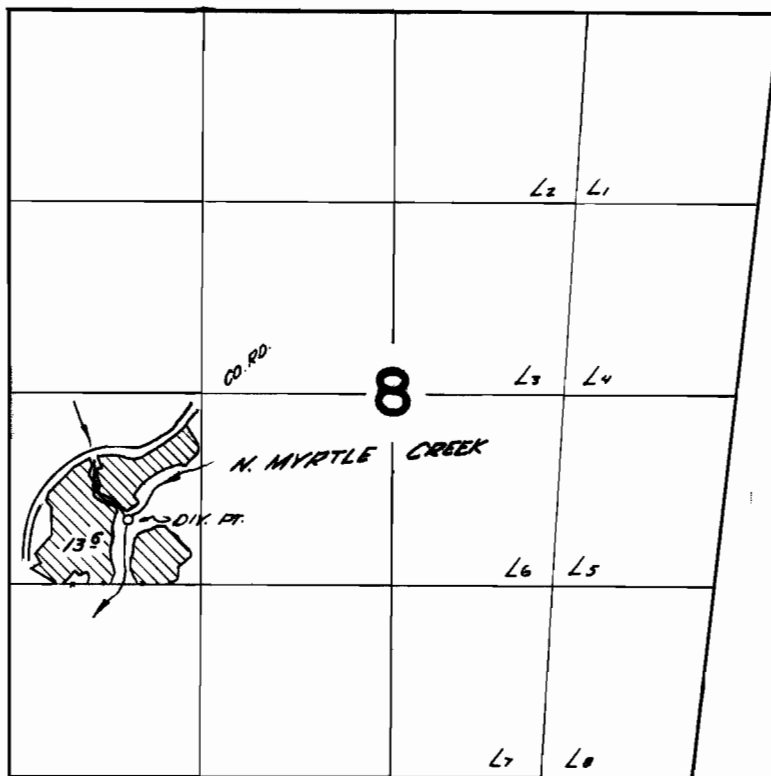

Div. Pt. located 440 ft. N. & 810 ft. E.
from the SW. cor. NW $\frac{1}{4}$ SW $\frac{1}{4}$ Sec. 8

FINAL PROOF SURVEY UNDER

Application No. 38219 Permit No. 28476
IN NAME OF

PHILIP J. and/or YIVIAN MURPHY

Surveyed Sept 20 1967, by V. Garner