

T.9S. R.5W. W.M.

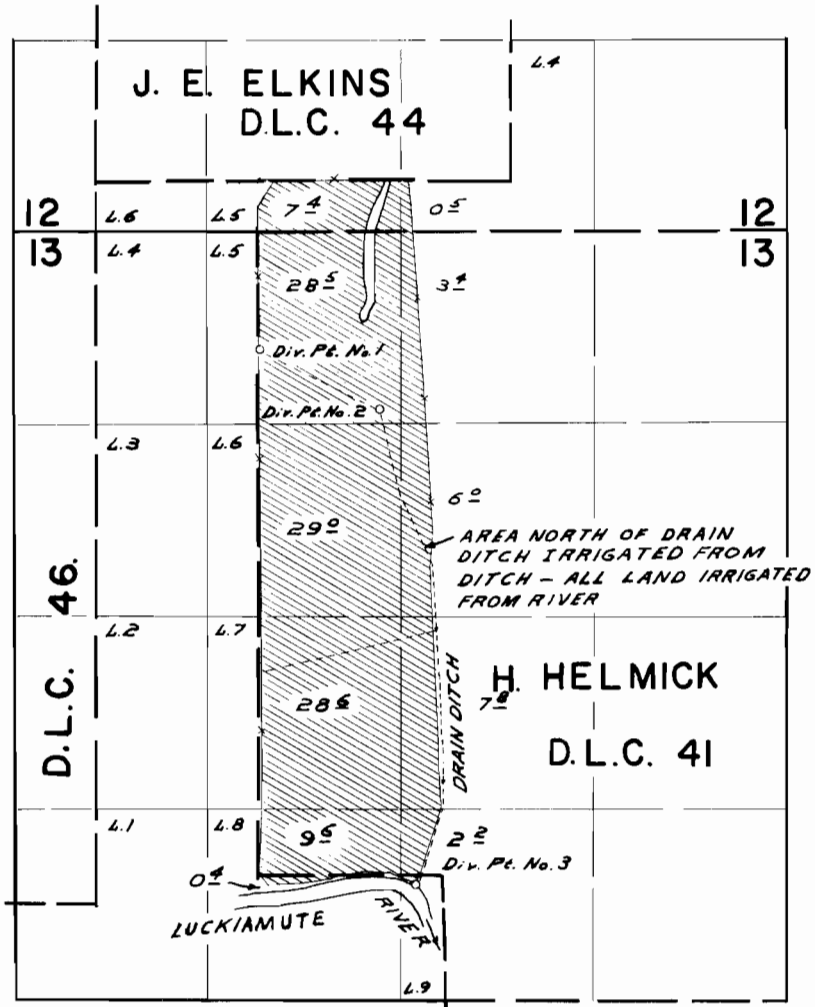

Div. Pt. No. 1 1150 ft. S. & 1710 ft. W.
Div. Pt. No. 2 1570 ft. S. & 900 ft. W. ALL FROM SE. COR. D.L.C. 44
Div. Pt. No. 3 4840 ft. S. & 640 ft. W.

FINAL PROOF SURVEY
UNDER

Application No. 38850 Permit No. 28898
IN NAME OF

LEONARD PETERS

Surveyed APR. 15, 1966, by *R. J. Duggan*