

T.2S.R.3W.W.M.

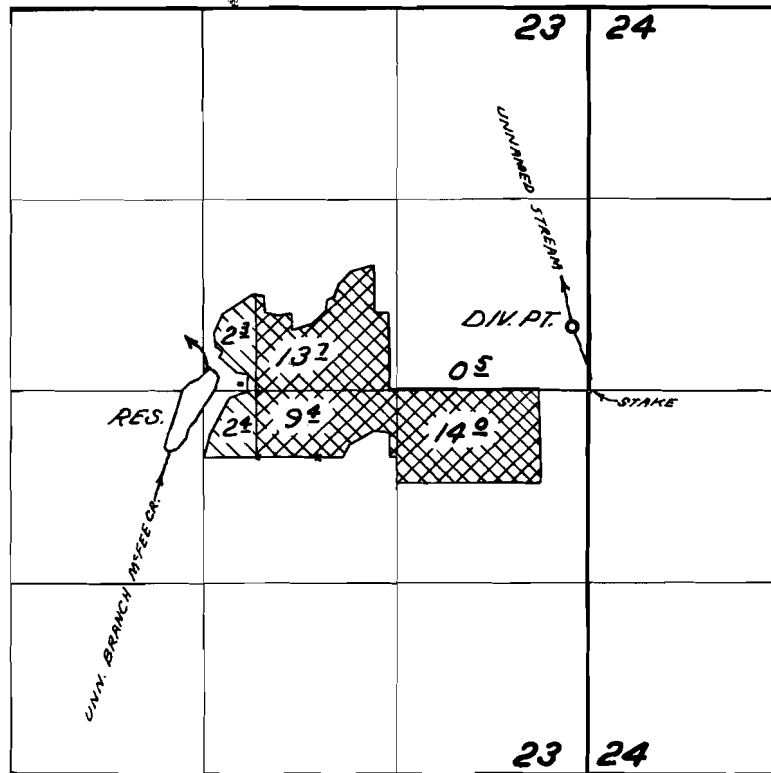

DIV. PTS. LOCATED:
 UNN. STREAM - 440' N. & 120' W.
 RESERVOIR - 150' N & 2610' W.
 BOTH FROM E 1/4 COR. SEC 23



UNN. STR.



RESERVOIR & UNN. BRANCH

FINAL PROOF SURVEY UNDER

Application No. R-38437 38438 Permit No. R-3271 28875
 IN NAME OF

ROBERT A. WEAVER

Surveyed AUG 11, 1967, by V. GARNER