

T. 7 N. R. 4 W. W. M.

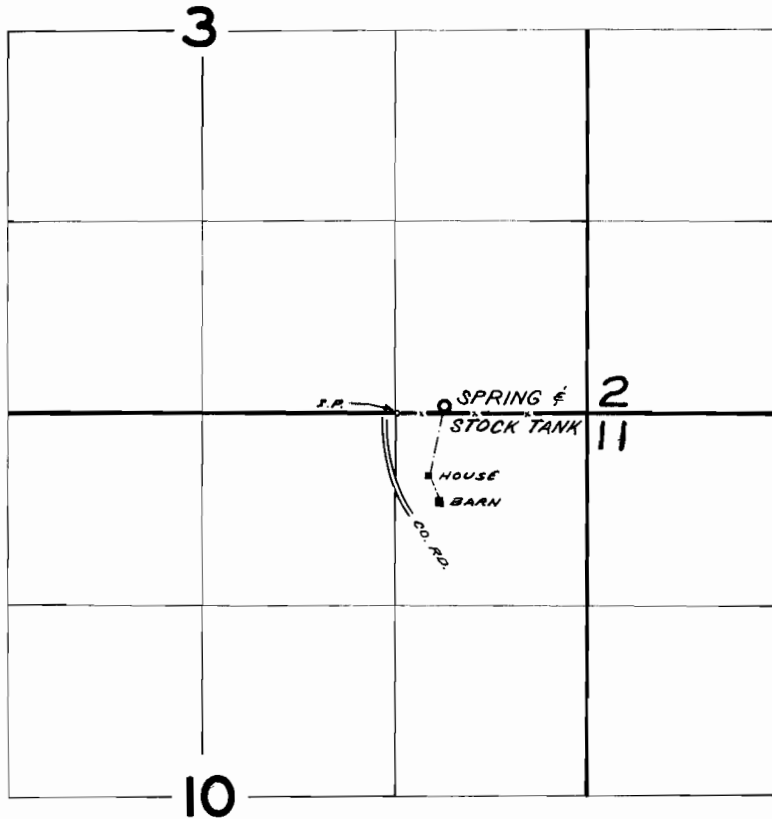

DIV. PT. LOCATED 50' N. AND 330' E. FROM NW COR. NE 1/4 NE 1/4

FINAL PROOF SURVEY  
UNDER

Application No. 42836 Permit No. 32017  
IN NAME OF

LEROY V. HIETALA

Surveyed AUG. 14 1967, by V. GARNER