

P-28768
36584
34880

T.13S.R29E. W.M.

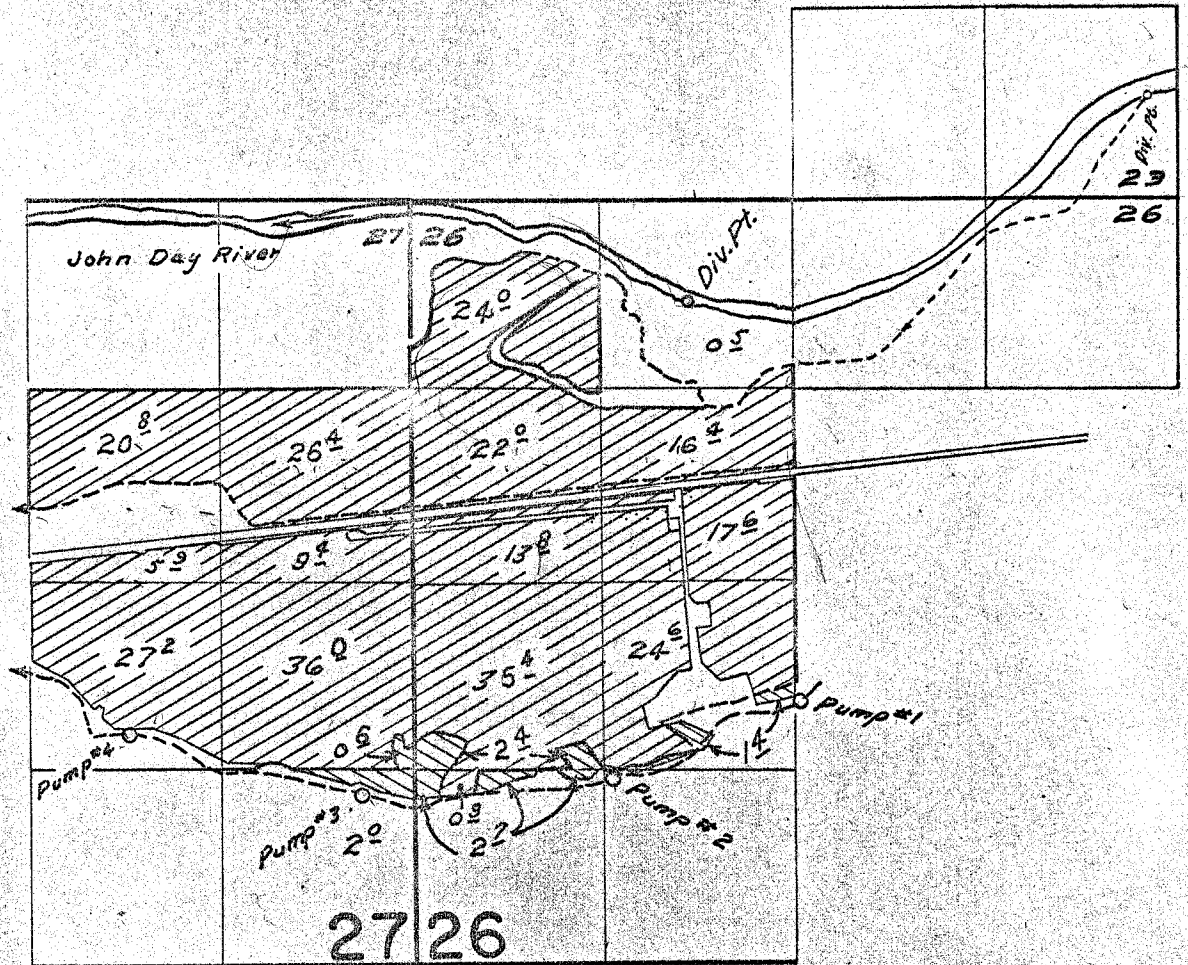

Supplemental
Primary

Diversion points located 690 ft. S. & 3260 ft. W. &
710 ft. N. & 200 ft. W. from N.E. Cor. Sec. 26

FINAL PROOF SURVEY UNDER

Application No. 38657... Permit No. 28768...
IN NAME OF

John E. McCaige

Surveyed Oct. 26, 1964, by R. Jackson...
June 21, 1967 by W.J. Ruppel.

1964-6