

G-2392

34898 CN

50502

T. 36 S. R. 12 E. W. M.

Sycam Riv. bed Sycam Marsh well

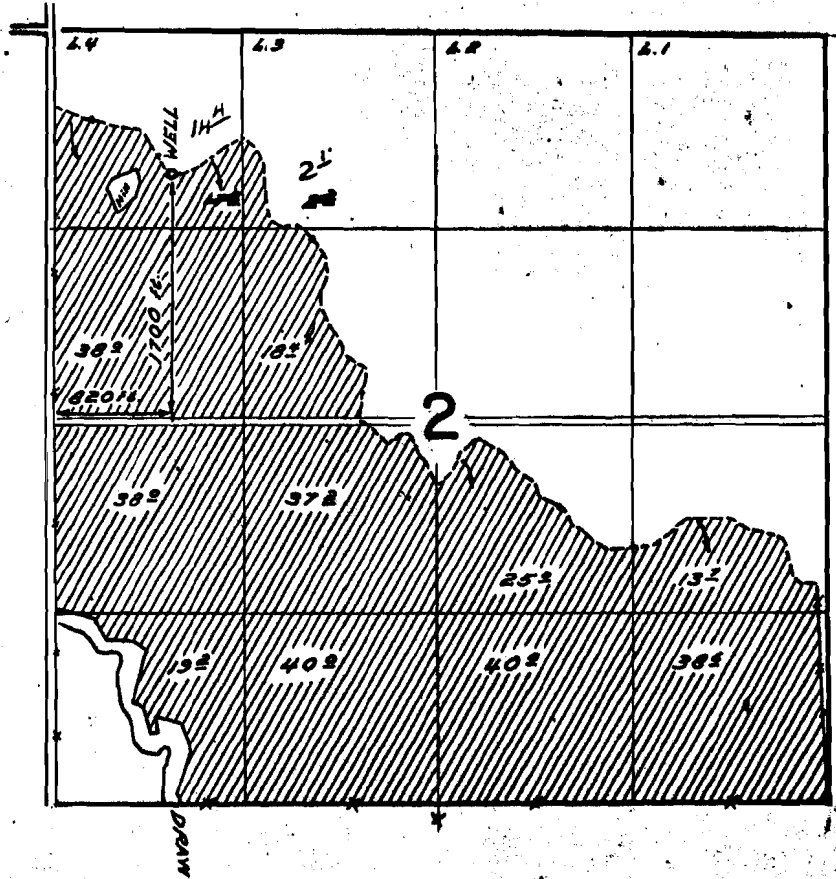

FINAL PROOF SURVEY UNDER

Application No. G-2580 Permit No. G-2392
IN NAME OF

L. L. Crawford

Surveyed Oct. 13 1956, by M. J. Ruppert