

T.5S.R.12E.W.M.

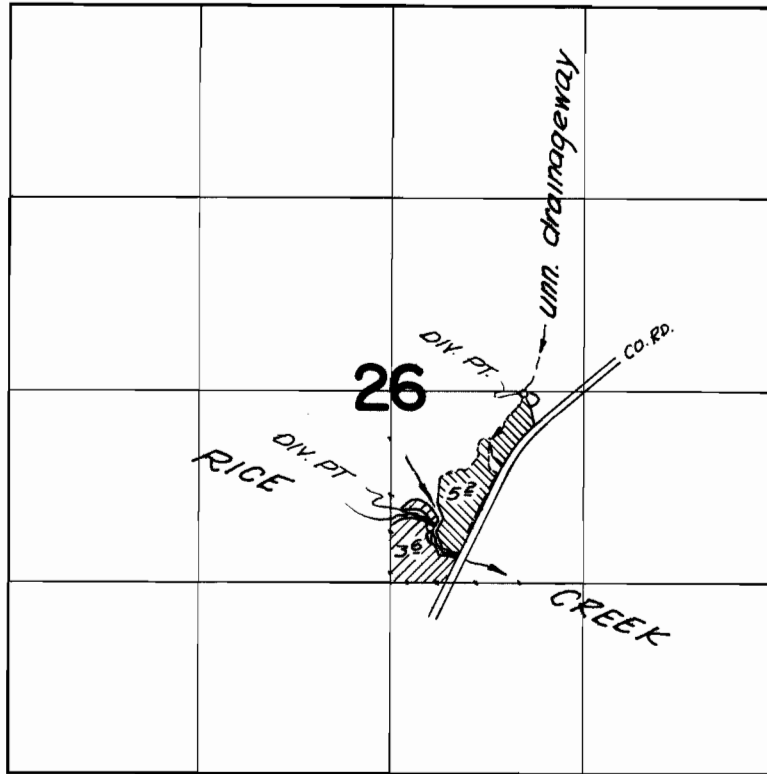

Div. pts. located 1300 ft. N. and 910 ft. E.; 380 ft. N. and 280 ft. E., both from the S.W. cor. NW $\frac{1}{4}$ SE $\frac{1}{4}$ Sec. 26

FINAL PROOF SURVEY UNDER

Application No. 39957 Permit No. 29838
IN NAME OF

ED and MARGARET BEEBE

Surveyed Nov. 6 1967, by V. Garner