

T.4S. R.10W. W.M.

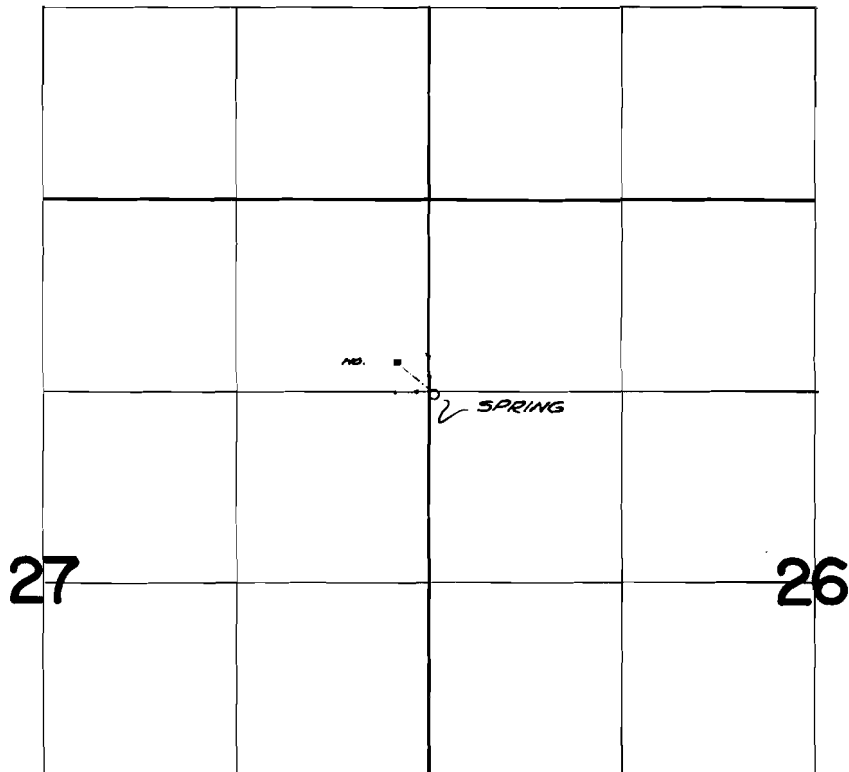

*Div. pt. located 11 ft S and 27 feet E from
the SE cor NE $\frac{1}{4}$ NE $\frac{1}{4}$ Sec 27*

FINAL PROOF SURVEY UNDER

Application No. 40891 Permit No. 30480
IN NAME OF

JESS J. STANNING

Surveyed Sept. 26, 1967, by V. Garner