

T. 26 S. R. 3 W. W.M.

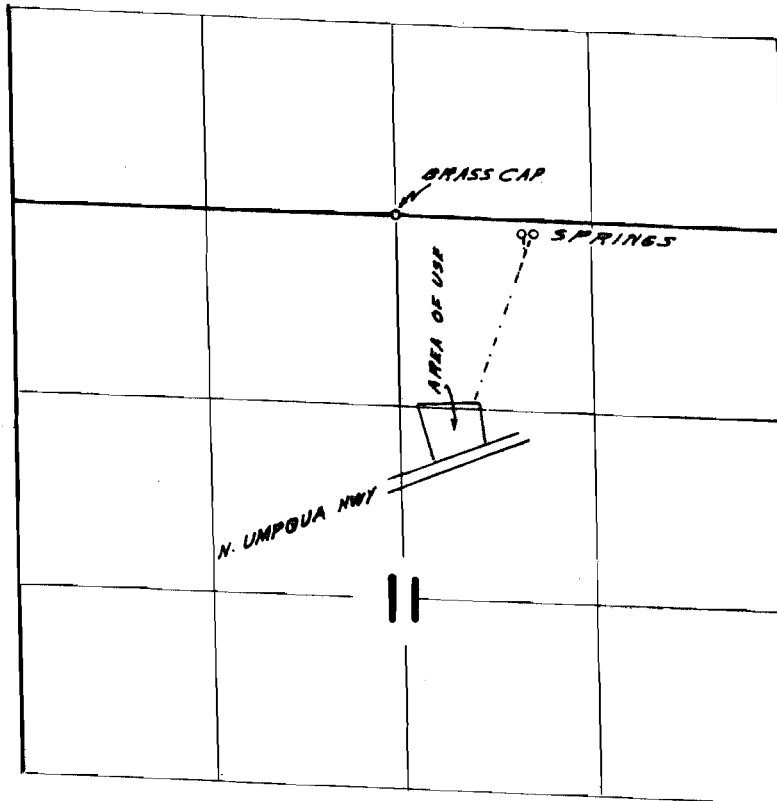

SPRINGS LOCATED 870 FT. E 940 JCR, AND 80TH 150 FT. S. FROM NORTH 1/4 CORNER OF SECTION 11.

FINAL PROOF SURVEY
UNDER

Application No. 41811..... Permit No. 31298..
IN NAME OF

OJ & Marian Henson.....

Surveyed June 8 1967, by W.D. Ruppert