

T.8S. R.38 & 39E. W.M.

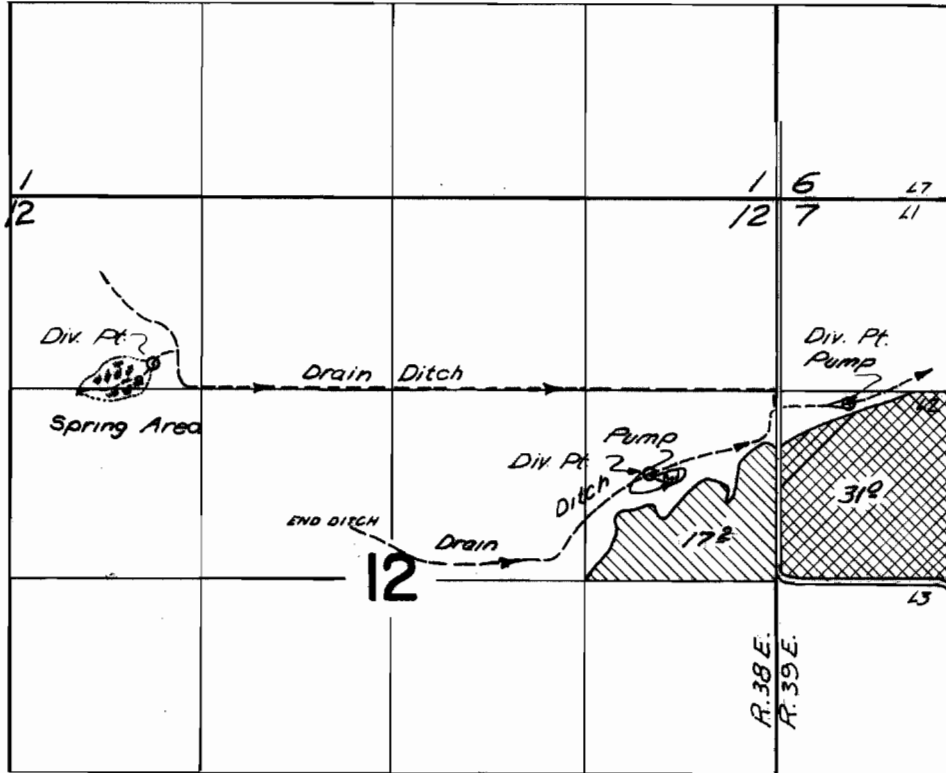

Div. pts. located 1150 ft. S. & 4290 ft. W.; 1900 ft. S. & 870 ft. W.;
1410 ft. S. & 490 ft. E.; all from the N.E. corner of Section 12



from drain ditch only



from spring and drain

FINAL PROOF SURVEY UNDER

Application No. 39273 Permit No. 29252
IN NAME OF

BEULAH SACKS

Surveyed Oct. 30 1967, by V. Garner