

T. 22 & 23 S. R. 31 E. W. M.

WELL LOCATED 1970 FE N.E. 160 FE. W. FROM S.E. CORNER SECTION 31

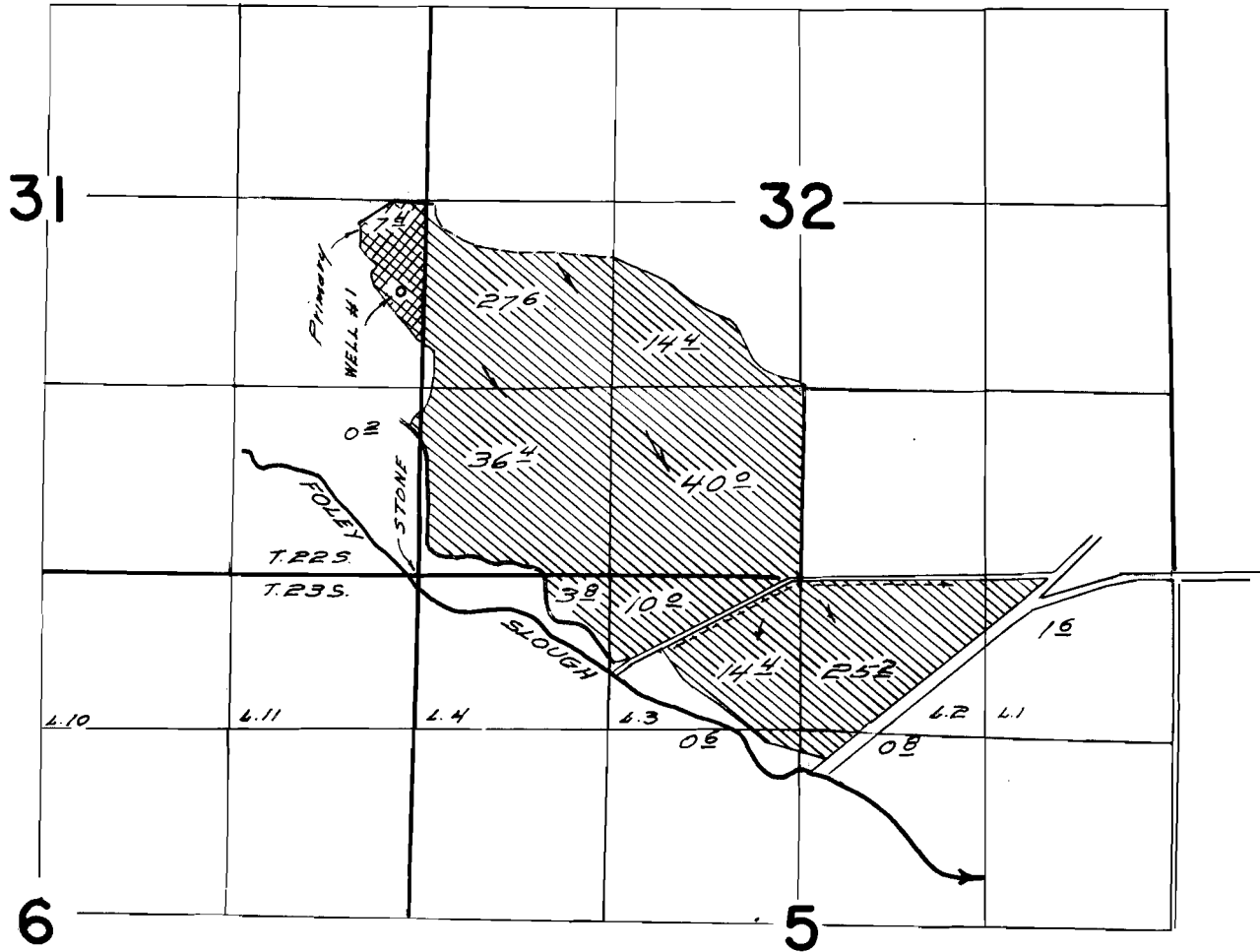

FINAL PROOF SURVEY UNDER

Application No. *G-1954* Permit No. *G-1798*
IN NAME OF

Harry Pom

Surveyed *Sept 13 1963* by *Carl Baker*
July 20, 1967 *W.J. Ruppert*