

T.2S. R.44 & 45 E.W.M.

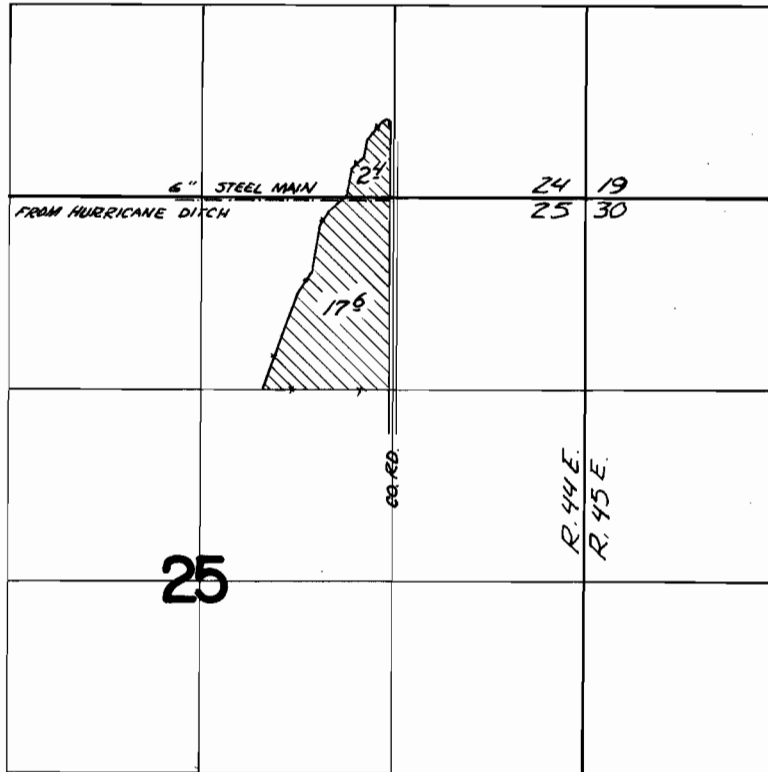

Div. pt. from Hurricane Creek located $5.76^{\circ} 02' W.$
 49 feet from the NE. cor. Sec. 3 T. 35, R. 44 E. W.M.
 (Reference See A-37981 P-28430)

FINAL PROOF SURVEY UNDER

Application No. 40572 Permit No. 30308
 IN NAME OF

EDWARD and IRENE REDMAN

Surveyed Oct. 4, 1967, by V. Garner