

T. 26 S. R. 6 W. W. M

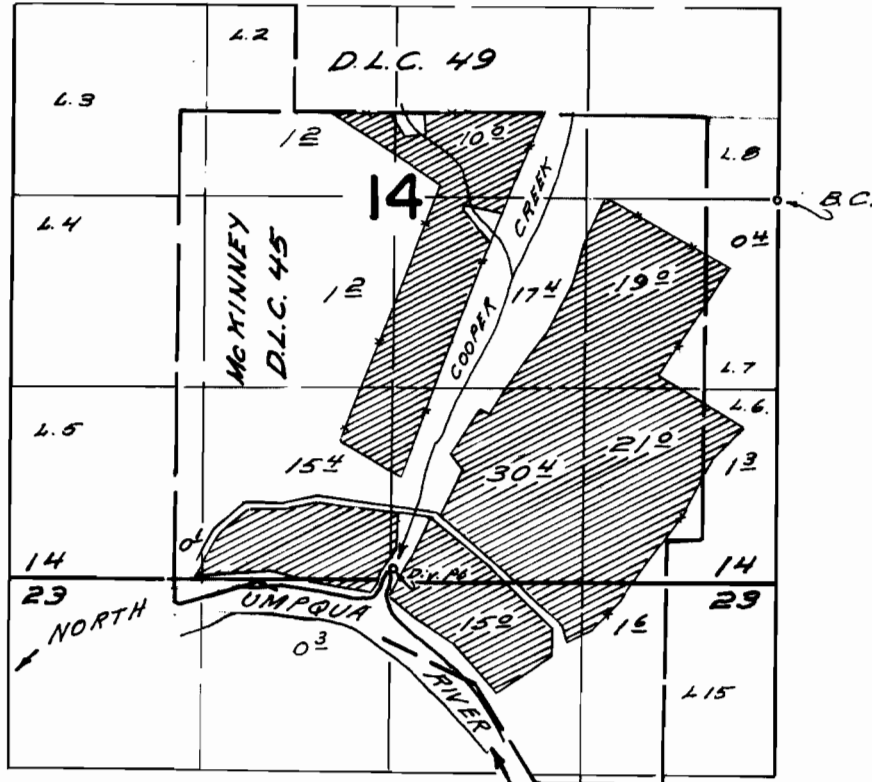

Division point located 2550 ft. S. & 2620 ft. W. from E. 1/4 Cor. Sec. 14.

FINAL PROOF SURVEY UNDER

Application No. 38746 Permit No. 28837
IN NAME OF

G. H. Harrell

Surveyed July 12, 1967, by W. H. Ruppert

T.26S., R.6W., W.M.

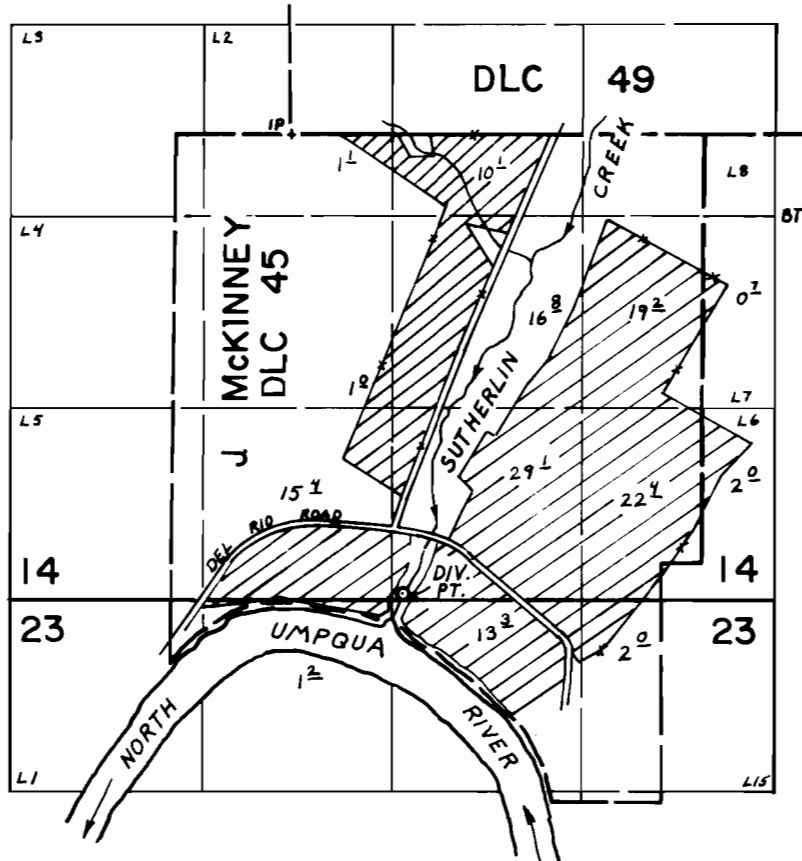

DIV. PT. LOCATED 40' N. & 2700' E. FROM S.W.
CORNER SEC. 14

SCALE: 4" = 1 mile

FINAL PROOF SURVEY
UNDER

Application No. 38746.. Permit No. 28837.....
IN NAME OF

.....G.H. HARRELL.....

Surveyed JULY 12 1967., by W. RUPPERT.....