

T.30S.R.5W.W.M.

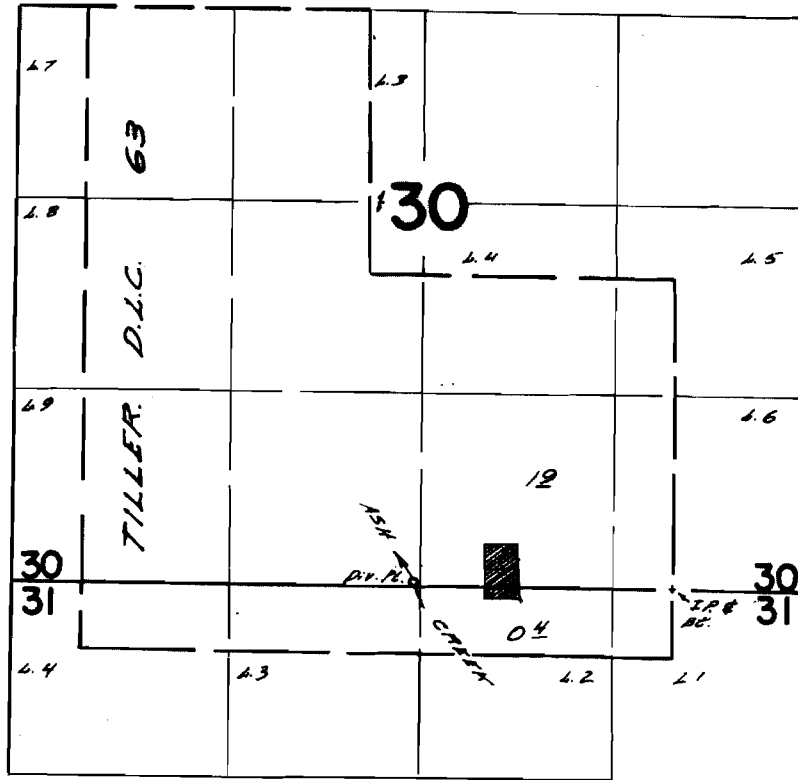

Diversion point located 20 ft. N. & 1780 ft. W. from SE cor Lot 6

FINAL PROOF SURVEY UNDER

Application No. 41891... Permit No. 31354
IN NAME OF

Gerald L. Nichols

Surveyed *Sept. 26 1967*, by *W. d. F. HARRIS*