

T. 26 S. R. 6 W. W.M.

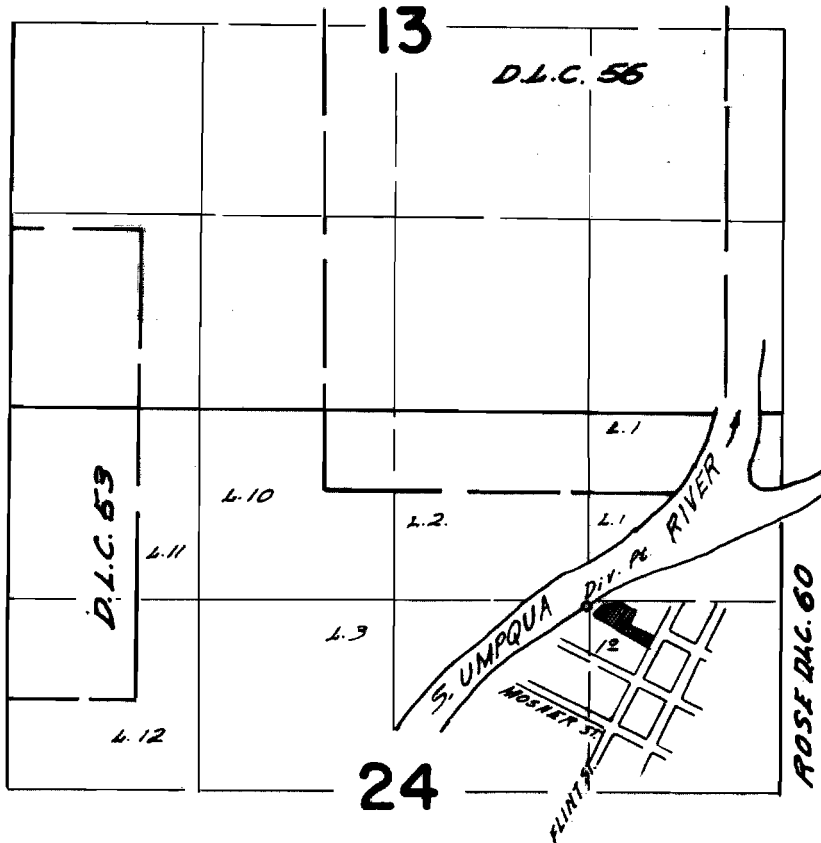

Diversion Pt. located 1330 N.S. & 1330 N.W. from  
N.E. Cor. Sec 24

**FINAL PROOF SURVEY**  
UNDER

Application No. 42191 Permit No. 31542  
IN NAME OF

Ernest Voorhies

Surveyed May 12 1967, by W.J. Ruppert