

T.21S. R.46E. W.M.

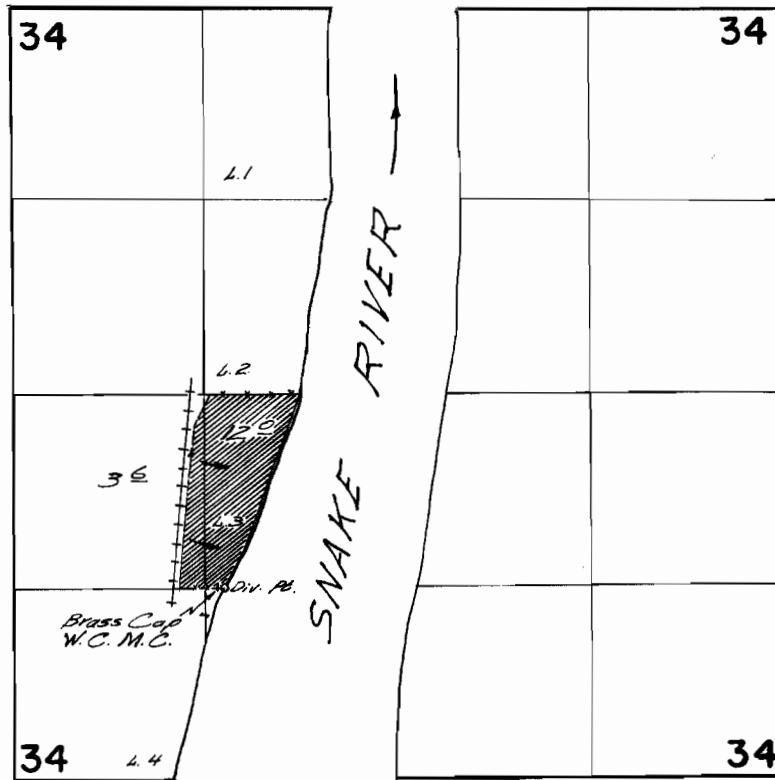

Diversion point located 130 ft. E. & 5 ft. N. from S.W. Cor. 163

FINAL PROOF SURVEY
UNDER

Application No. 43017 Permit No. 32161
IN NAME OF

Charles M. Chase

Surveyed Nov. 2, 1967, by *W. J. Reppert*