

# T.28 S.R.11 W.W.M.

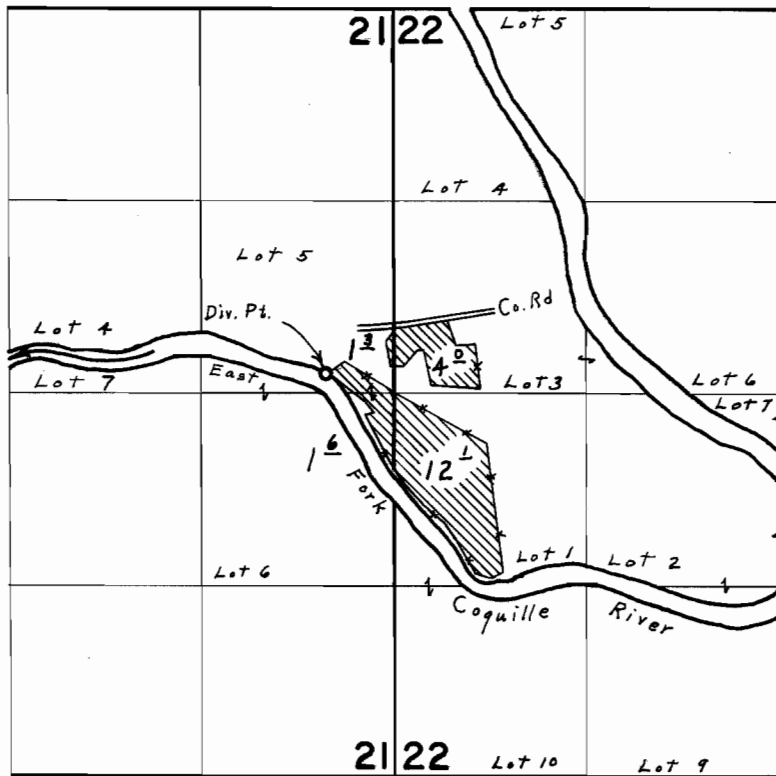

Div. Pt. located 130' N. & 460' W. from the E.  $\frac{1}{4}$  Cor. Sec. 21

## FINAL PROOF SURVEY UNDER

Application No. 41008 Permit No. 30575  
IN NAME OF  
**GEORGE R. BROCKWAY**

Surveyed May 20, 1967, by L. E. Gould