

G-3105
35599

T.4N.R.29E.W.M.

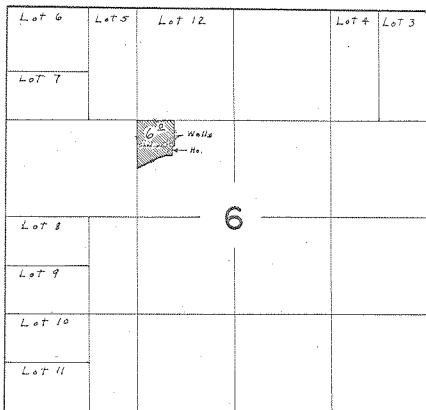

Wells located, $380^{\circ}E. \& 330^{\circ}S.$, $670^{\circ}E. \& 330^{\circ}S.$ both from N.W. Cor. S.E. $\frac{1}{4}$ N.W. $\frac{1}{4}$ Sec. 6

FINAL PROOF SURVEY UNDER

Application No. G-3447 Permit No. G-3105
IN NAME OF

LARRY D. EADES

Surveyed June 29, 1967, by L.E. Gould