

T. 22 S. R. 6 W. W.M.

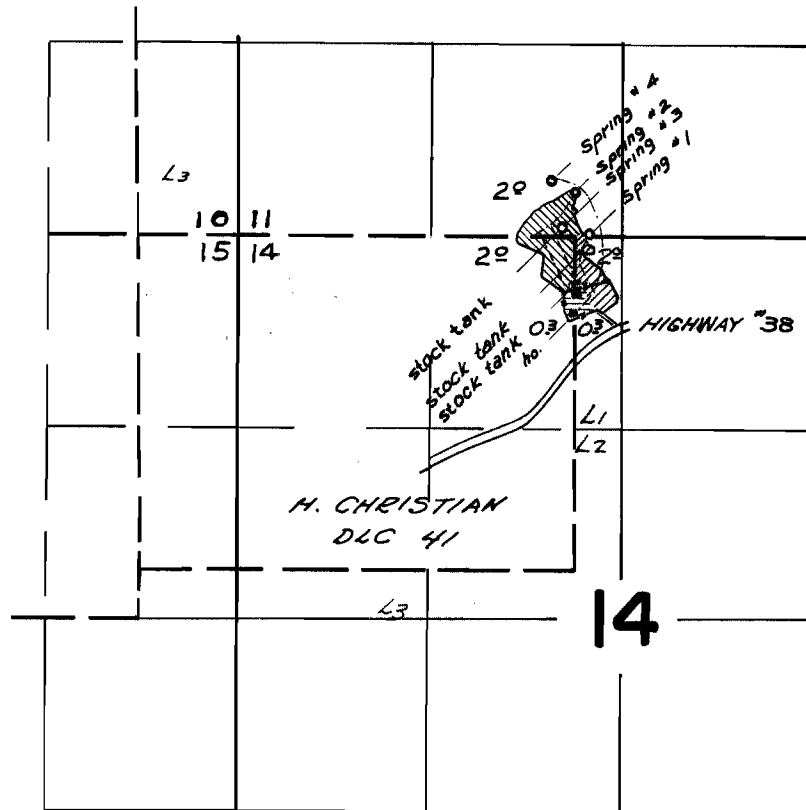

- Spring #1 20 ft. N. of 230 ft. W. from the N. $\frac{1}{4}$ cor. Sec. 14
- Spring #2 310 ft. N. of 320 ft. W. from the N. $\frac{1}{4}$ cor. Sec. 14
- Spring #3 60 ft. N. of 420 ft. W. from the N. $\frac{1}{4}$ cor. Sec. 14
- Spring #4 380 ft. N. of 490 ft. W. from the N. $\frac{1}{4}$ cor. Sec. 14

FINAL PROOF SURVEY UNDER

Application No. 37869 Permit No. 28285
IN NAME OF

RAYMOND O. and ETHEL L. STALEY

Surveyed May 18, 1966, by V. GARNER