

T.I.S.R.I.E.W.M.

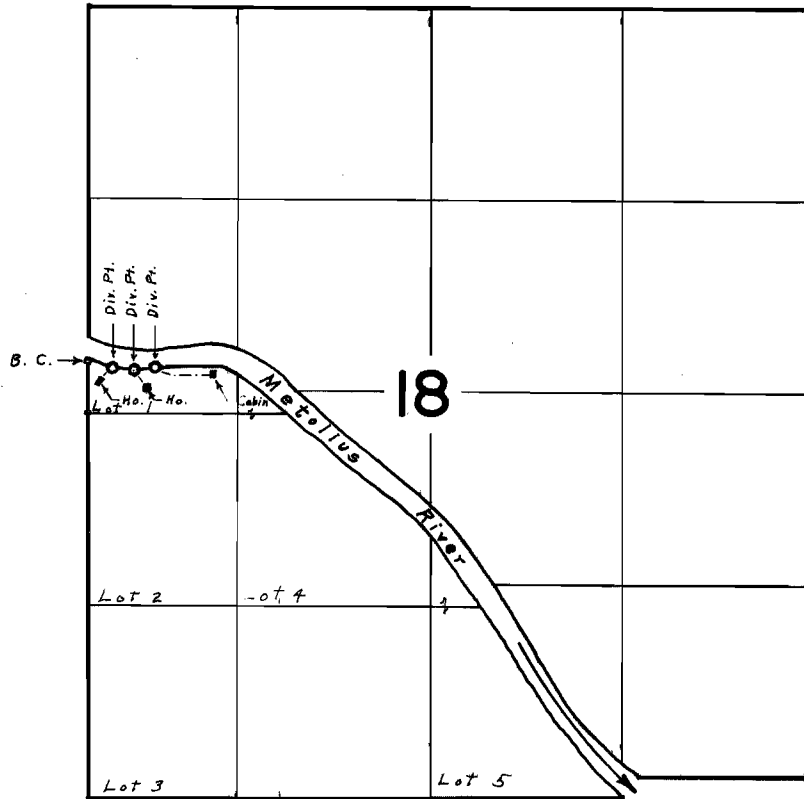

Div. Pts. located; #1, 310' N., 170' E., #2, 290' N., 320' E., #3, 310' N., 460' E.,
All from the S.W. Cor. Lot 1, Sec. 18

FINAL PROOF SURVEY UNDER

Application No. 39935 Permit No. 29895

IN NAME OF

MRS. LEE EYERLY

Surveyed July 13, 1967, by L. E. Gould