

# T. 11 S. R. 3 W. W. M.

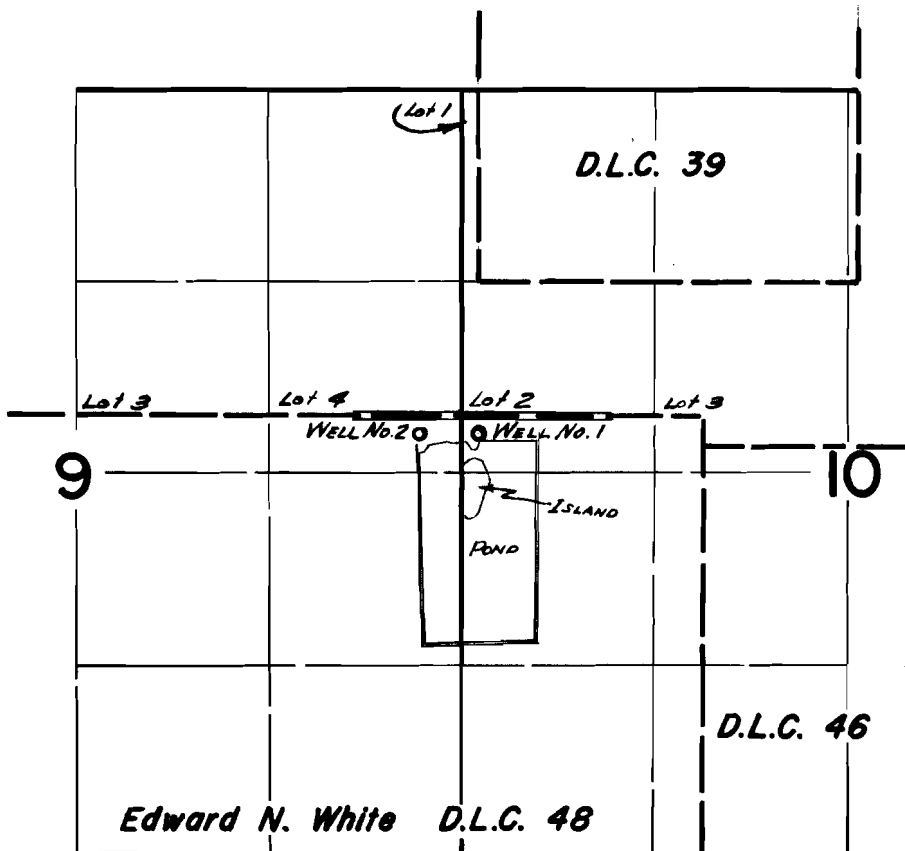

Well No. 1 is located 120 ft. south & 1530 ft. west  
Well No. 2 is located 120 ft. south & 1940 ft. west  
both from N.E. corner D.L.C. 48

## FINAL PROOF SURVEY UNDER

Application No. G-3051... Permit No. G-2847.  
IN NAME OF

*JOHN GISLER*

Surveyed April 7, 1966, by *R. Jackson*