

T. 16S. R. 22E. W.M.

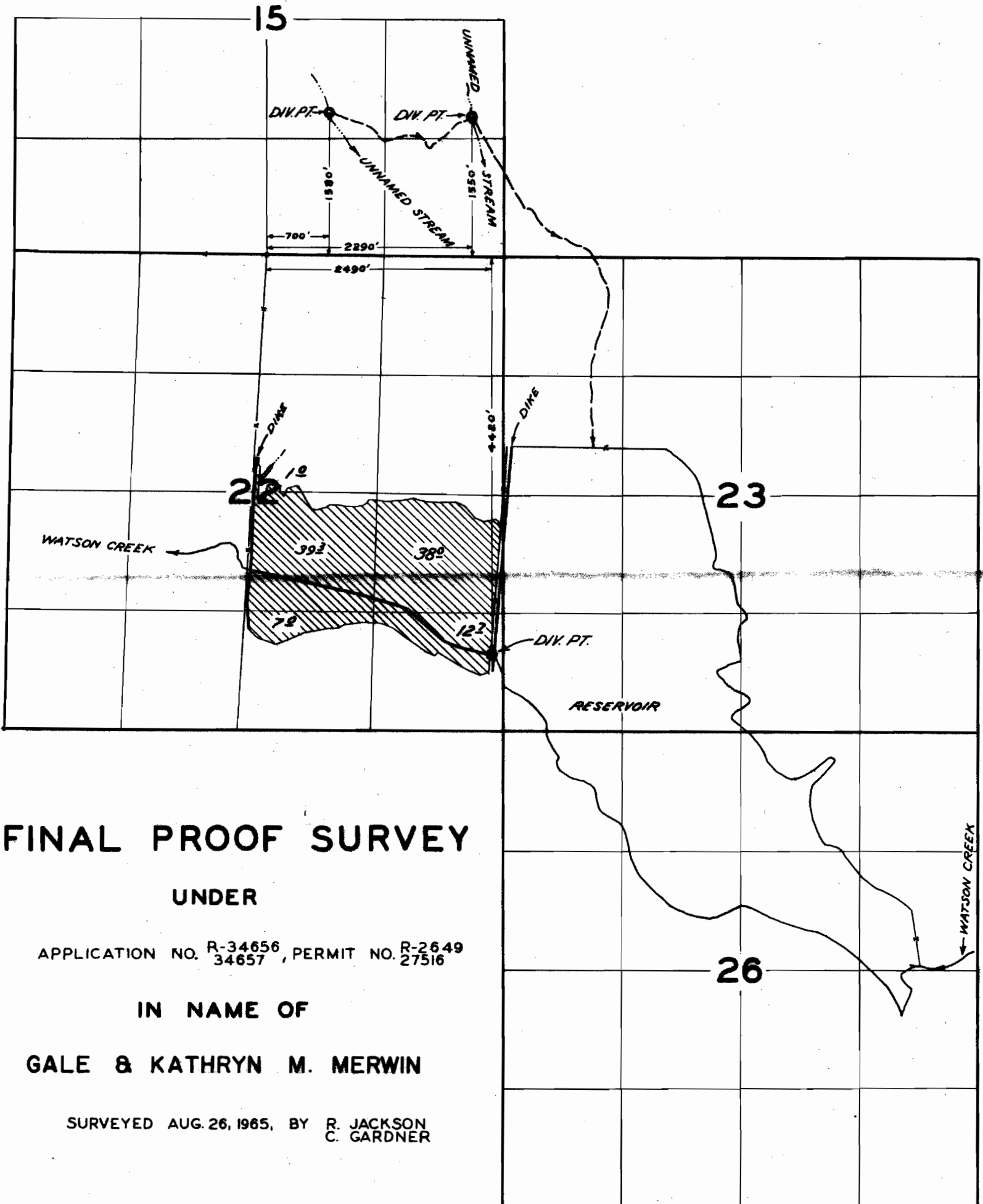

FINAL PROOF SURVEY

UNDER

APPLICATION NO. R-34656, PERMIT NO. R-2649
34657, 27516

IN NAME OF

GALE & KATHRYN M. MERWIN

SURVEYED AUG. 26, 1985, BY R. JACKSON
C. GARDNER