

T. 35 S. R. 4 W. W. M.

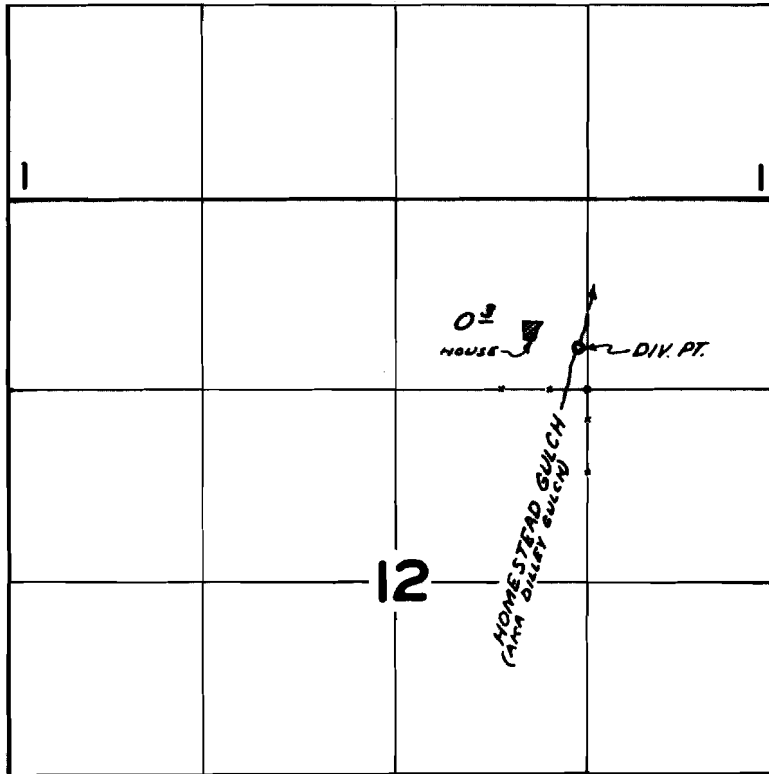

DIV. PT. LOCATED 290' N. & 70' W. FROM SE COR. NW 1/4 NE 1/4 SEC 12

**FINAL PROOF SURVEY**  
UNDER

Application No. 41875 Permit No. 31329  
IN NAME OF

RICHARD E. OLYMPIUS

Surveyed JUN 6 1968, by V. GARNER