

# T.27 & 28 S.R.14 W.W.M.

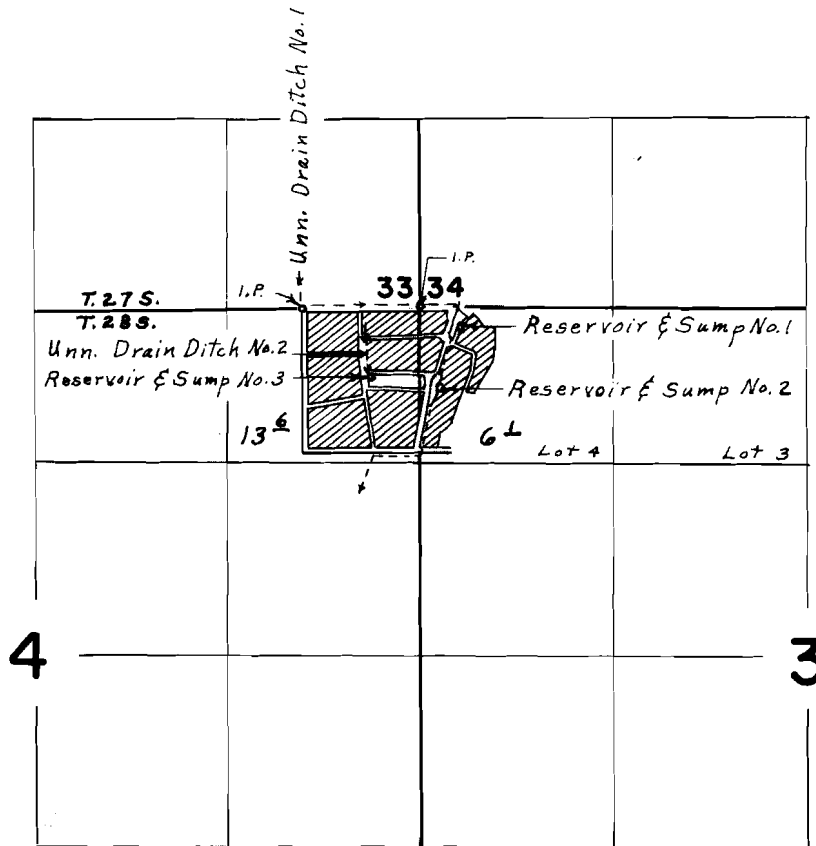

Res., Sumps, & Div. Pts. located: No. 1, 100' S. & 260' E.; No. 2, 550' S. & 100' E.; No. 3, 500' S. & 150' W.; all from N.W. Corner Sec. 3

## FINAL PROOF SURVEY UNDER

G-2756                      G-2561  
R-39324                    R-3900  
Application No. 39325 Permit No. 29282

IN NAME OF

**VANCE RUSSELL**

Surveyed July 9, 1968, by L. E. Gould