

# T.27 & 28 S.R.14 W.W.M.

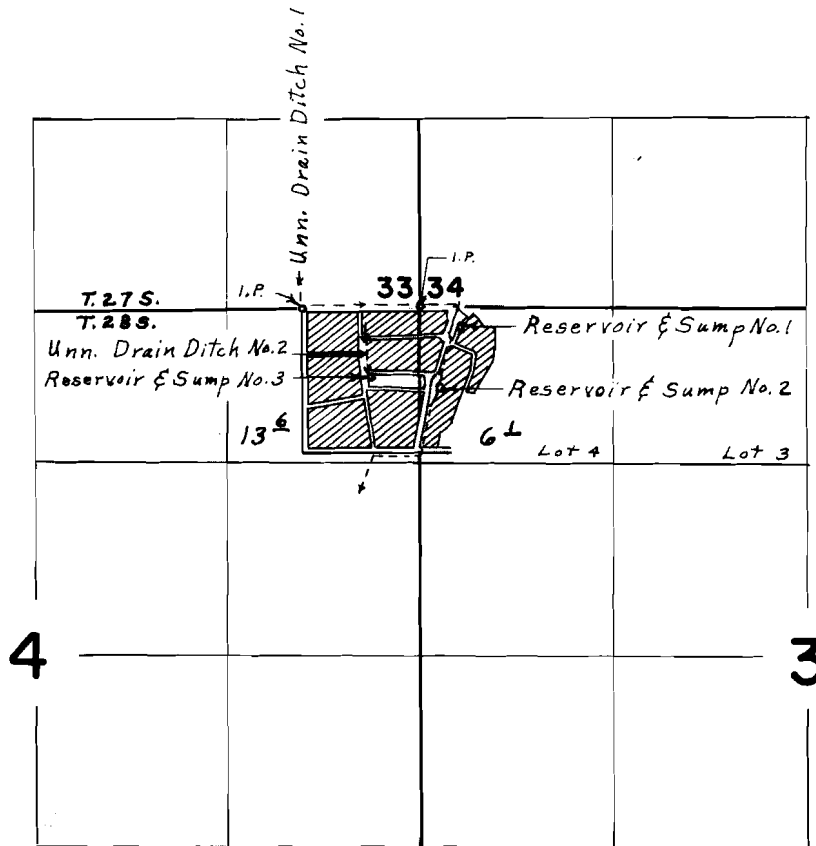

Res., Sumps, & Div. Pts. located: No. 1, 100' S. & 260' E.; No. 2, 550' S. & 100' E.; No. 3, 500' S. & 150' W.; all from N.W. Corner Sec. 3

## FINAL PROOF SURVEY UNDER

G-2756                      G-2561  
R-39324                    R-3900  
Application No. 39325 Permit No. 29282

IN NAME OF  
**VANCE RUSSELL**

Surveyed July 9, 1968, by L. E. Gould

35938

DEPARTMENT OF AGRICULTURE  
FOREST SERVICE  
FIELD MAP SHEET

Scale 8 inches = 1 mile.  
T. 15S R. 25E Sec. 33  
Mag. Dec. \_\_\_\_\_ Acres \_\_\_\_\_

WATER RIGHT  
RAGER WELL  
Roger Ranger Station Unit  
(Case designation)

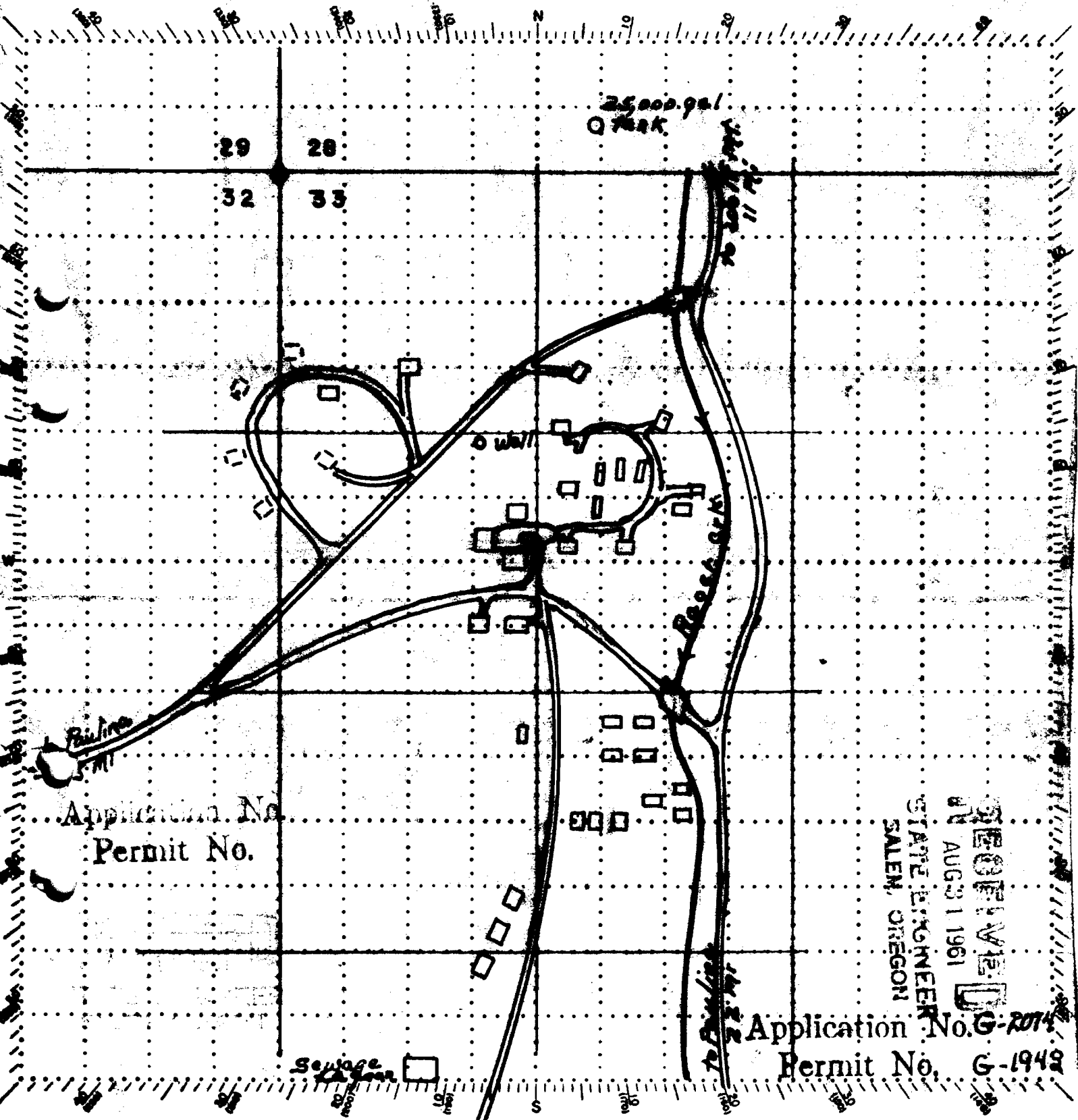

Application No. \_\_\_\_\_  
Permit No. \_\_\_\_\_

GEORGE W. J. D  
STATE ENGINEER  
AUG 31 1961  
SALEM, OREGON

Application No. G-2014  
Permit No. G-1942

Field work by T. S. Webb Date May 2, 1961 Platted by M. K. McCoy  
Remarks 880' of 2 1/2" and 310' of 3" pipe from well to tank

Approved \_\_\_\_\_ 19 \_\_\_\_\_  
U. S. GOVERNMENT PRINTING OFFICE 16-50750-1