

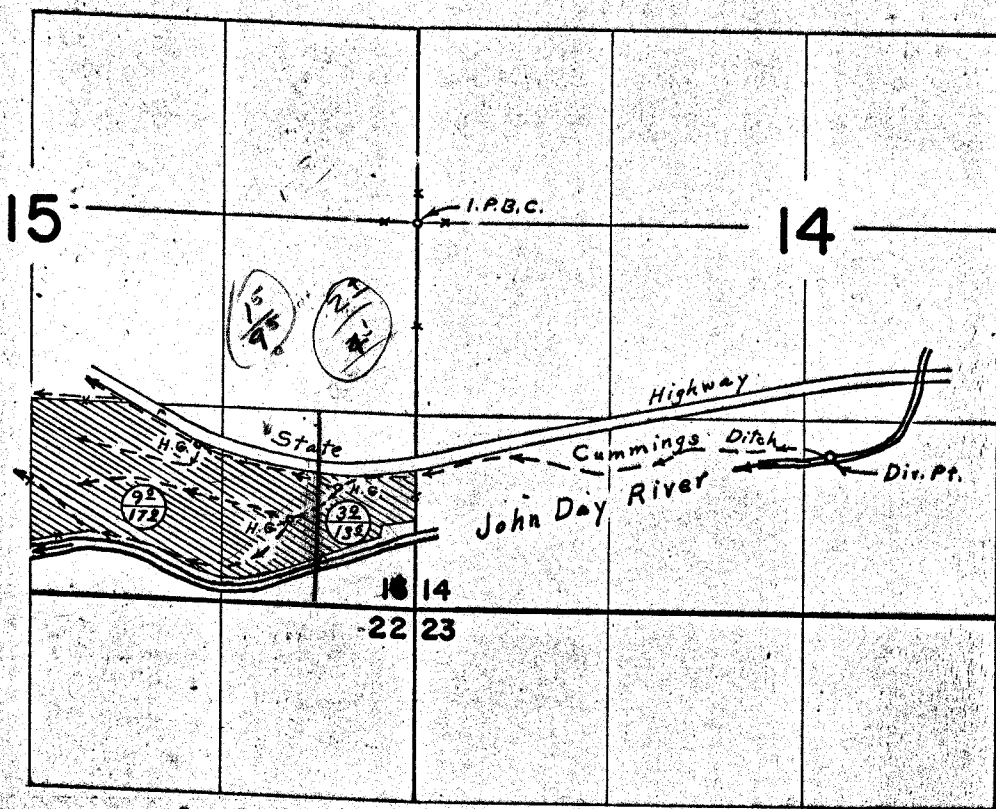

# T.13 S.R.28 E.W.M.



Div. Pt. located 1560' S. & 2830' E. from W. & Cor. Sec. 14.

Permit No. 28064  
Prior Rights 

## FINAL PROOF SURVEY UNDER

Application No. 37642 Permit No. 28064  
IN NAME OF

JAMES A. WYLLIE

Surveyed June 5, 1968, by L. E. Gould