

T.10S. R.4W. W.M.

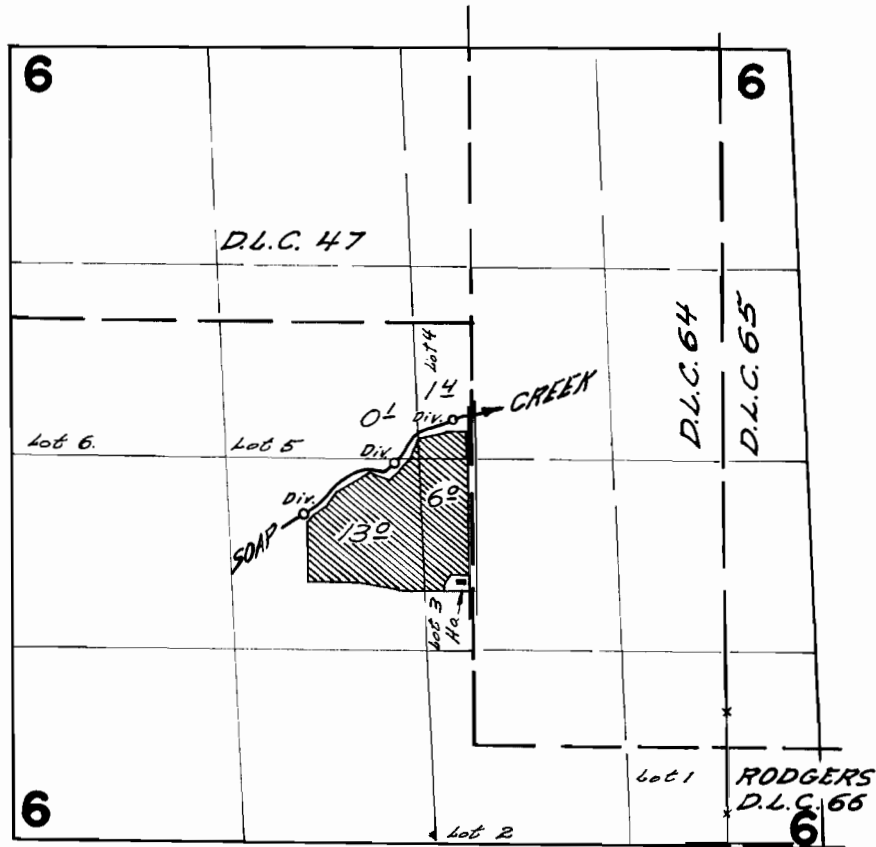

DIVERSION POINTS LOCATED 2260 F.N. & 2880 F.G. W.
 2610 F.N. & 2250 F.G. W.
 2920 F.N. & 1850 F.G. W.
 ALL FROM THE MOST WESTERLY SW. CORNER D.L.C. 66

FINAL PROOF SURVEY UNDER

Application No. 35208 Permit No. 27545
 IN NAME OF

RALPH B. GRAHAM

Surveyed Aug 16, 1965, by C. GARDNER
Sept. 26, 1968 by W.J. Fluppert