

# T.5S.R.3W.W.M.

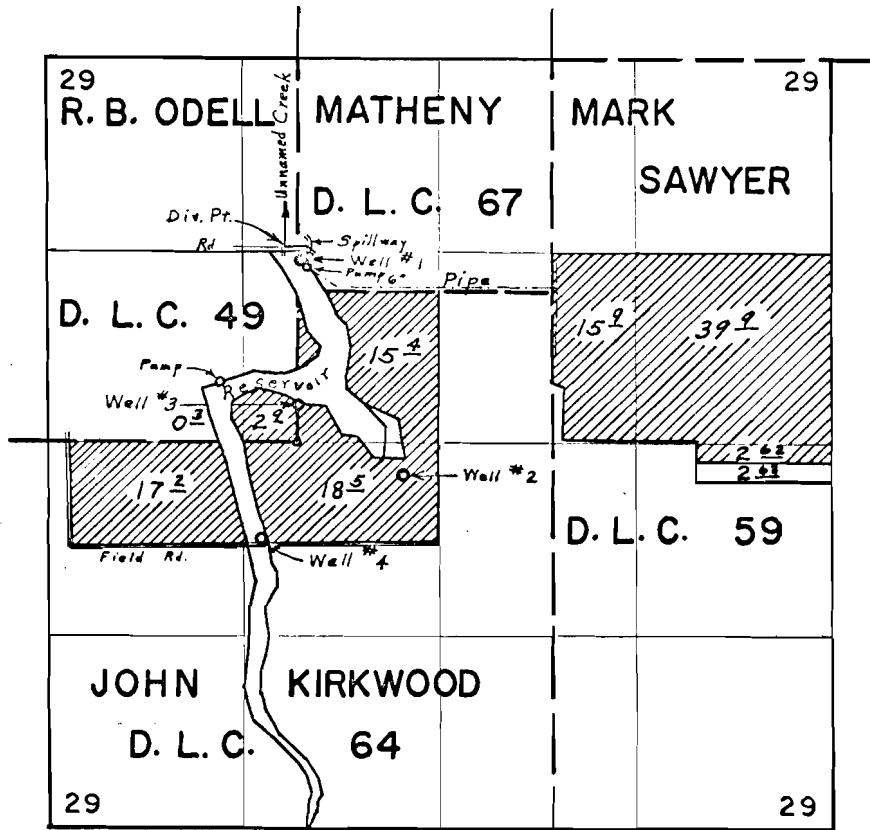

Well #1 located 1260' N. & 20' E. From the N. Reentrant Cor. D.L.C. 64  
 Well #2 located 220' S. & 720' E. From the N. Reentrant Cor. D.L.C. 64  
 Well #3 located 260' N. & 5' E. From the N. Reentrant Cor. D.L.C. 64  
 Well #4 located 660' S. & 235' W. From the N. Reentrant Cor. D.L.C. 64  
 Div. Pt. located 1320' N. & 30' W. From the N. Reentrant Cor. D.L.C. 64  
 Co. Rd.

## FINAL PROOF SURVEY UNDER

R-40875                      R-4596  
 40876                      30530  
 Application No. G-3124      Permit No. G-2921  
 IN NAME OF

**ROBERT L. JANZEN**

Surveyed April 6, 1967, by L. E. Gould