

T.5S.R.3W.W.M.

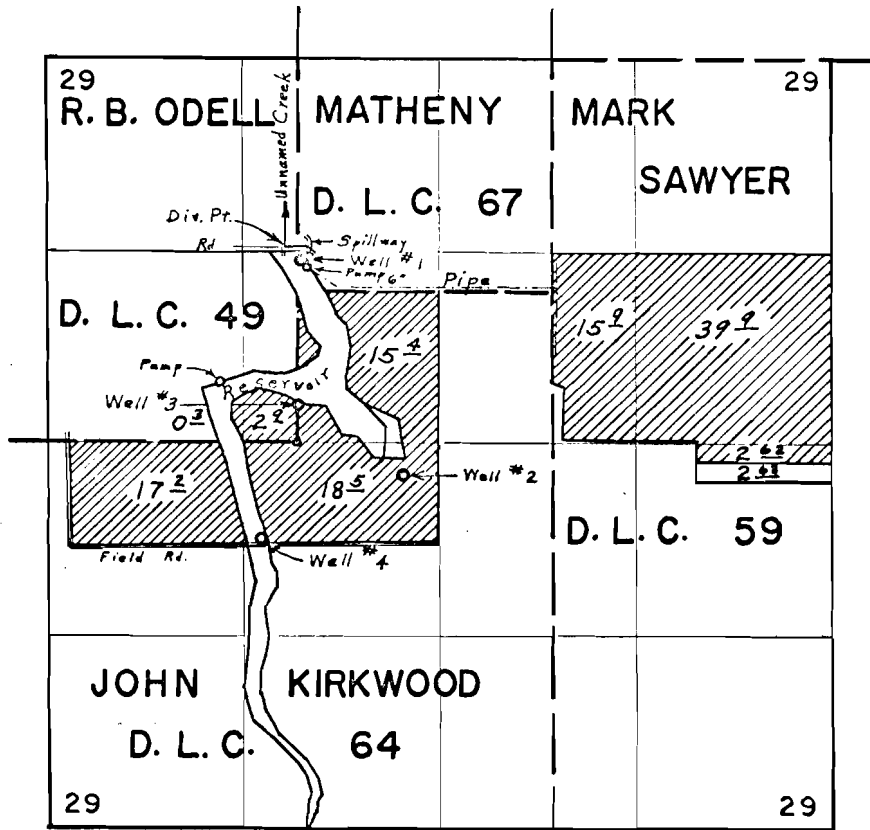

Well #1 located 1260' N. & 20' E. From the N. Reentrant Cor. D.L.C. 64	Reentrant Cor. D.L.C. 64
Well #2 located 220' S. & 720' E. From the N. Reentrant Cor. D.L.C. 64	Reentrant Cor. D.L.C. 64
Well #3 located 260' N. & 5' E. From the N. Reentrant Cor. D.L.C. 64	Reentrant Cor. D.L.C. 64
Well #4 located 660' S. & 235' W. From the N. Reentrant Cor. D.L.C. 64	Reentrant Cor. D.L.C. 64
Div. Pt. located 1320' N. & 30' W. From the N. Co. Rd.	Reentrant Cor. D.L.C. 64

FINAL PROOF SURVEY UNDER

R-40875 R-4596
 40876 30530
 Application No. G-3124 Permit No. G-2921
 IN NAME OF

ROBERT L. JANZEN

Surveyed April 6, 1967, by L. E. Gould