

T. 9S. R. 27E. W.M.

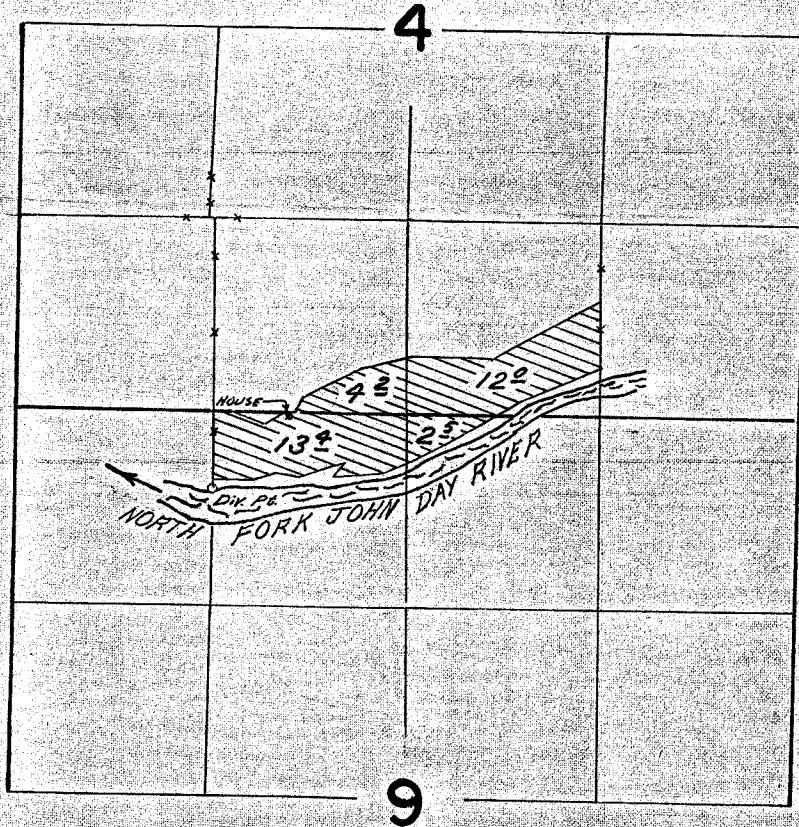

DIVERSION POINT LOCATED 1850185 ± 5' ± E FROM
NW CORNER SE 1/4 SW 1/4 SEC. 4.

FINAL PROOF SURVEY
UNDER

Application No. 37834. Permit No. 28208
IN NAME OF

J. DONALD CAPON

Surveyed May 23, 1968, by *W. J. Ruppert*