

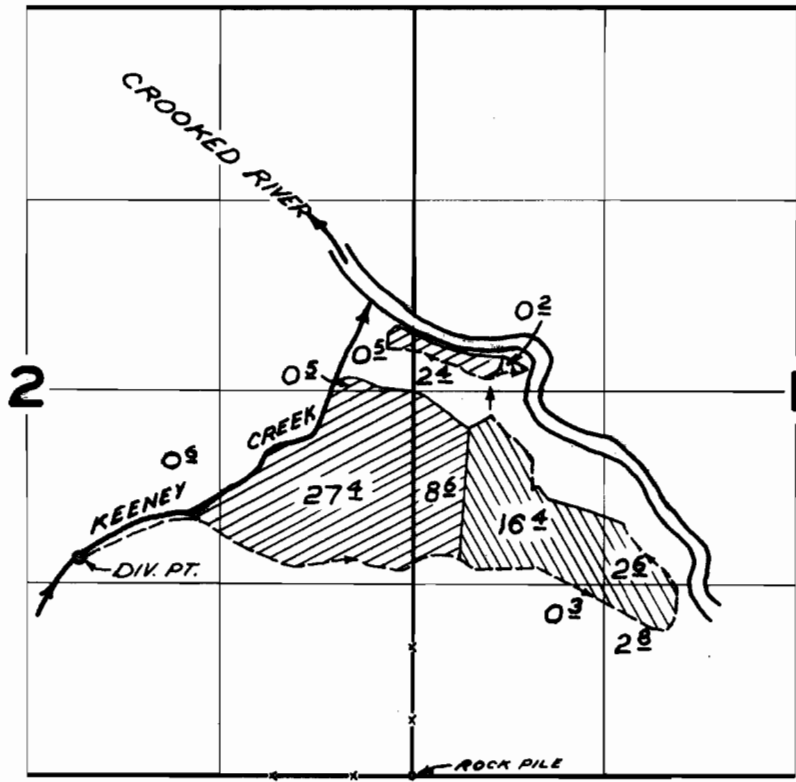

# T.17 S.R.20E.W.M.



 PRIMARY  
 SUPPLEMENTAL

Div. Pt. located 1500 ft. N. & 2290 ft. W. from S.E. Cor. Sec. 2

## FINAL PROOF SURVEY UNDER

Application No. 28023 Permit No. 25064  
IN NAME OF

**F. S. McCULLOUGH**

Surveyed Oct 1 1960, by R. JACKSON