

T.34S.R.IW.W.M.

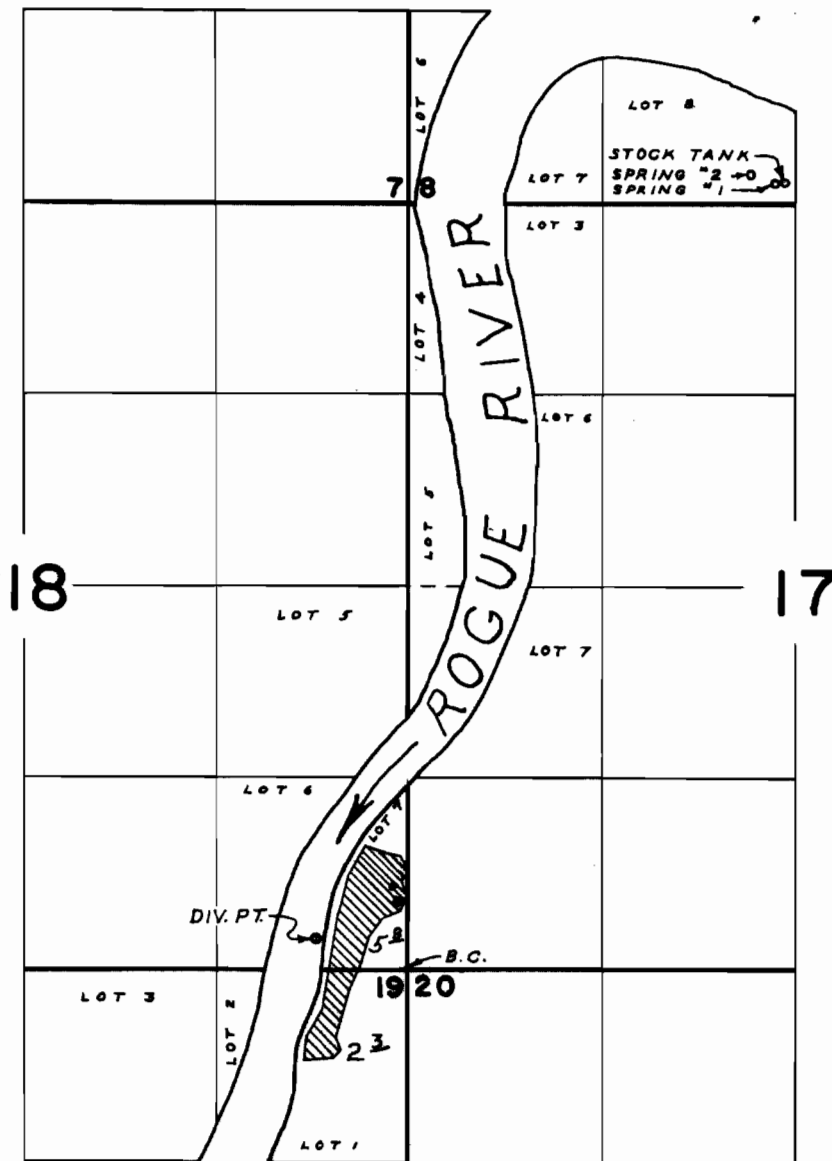

SPRINGS LOCATED: "1; 150' N & 130' W; "2; 200' N & 310' W: FROM S & E COR. SEC. 9. DIV. PT. LOCATED 220' N & 630' W FROM SE COR. SEC. 18

FINAL PROOF SURVEY UNDER

Application No. **34857**... Permit No. **27358**...
IN NAME OF

WILLIAM FITZSTEPHENS

Surveyed **SEPT. 11, 1968**, by **L. E. GOULD**