

# T.1N.R.13E.W.M.

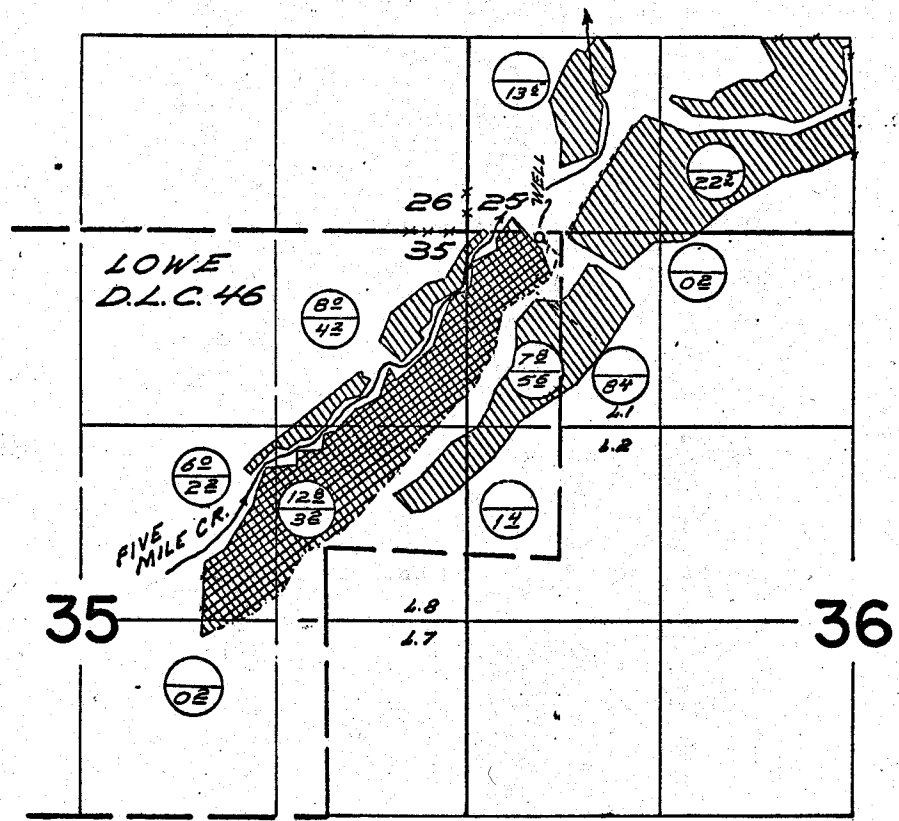

Well located 500ft. E. & 20ft. S. from N.W. corner Section 36

 SUPPLEMENTAL  
 PRIMARY  
  

## FINAL PROOF SURVEY UNDER

Application No. G-2599 Permit No. G-2511...  
IN NAME OF

*James W. & Echo M. Oades*

Surveyed July 19, 1967, by *W. S. Ruppert*