

T. 31 S. R. 4 W. W.M.

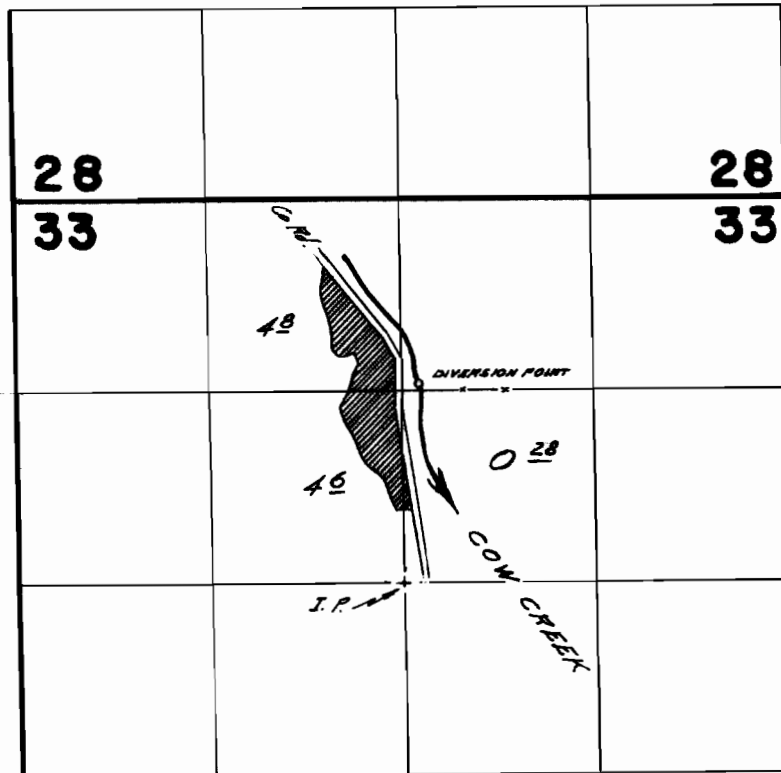

DIVERSION POINT LOCATED 1370 FB N. & 110 FB. E. FROM CENTER
1/4 CORNER SECTION 33

FINAL PROOF SURVEY
UNDER

Application No. 40377 Permit No. 30102
IN NAME OF

FRANK M. WALCHEL

Surveyed April 29 1968, by W. D. Rupperts