

T. 36S. R. 3W. W.M.

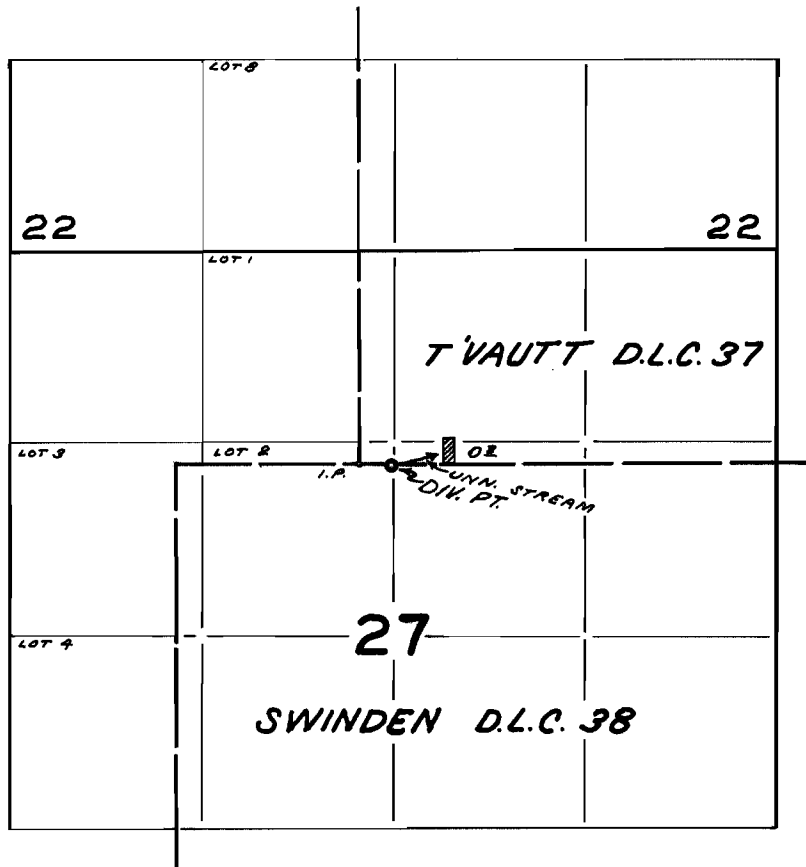

DIV. PT. LOCATED 220' E. AND 10' S. FROM SW COR. DLC 37

FINAL PROOF SURVEY
UNDER

Application No. 39427 Permit No. 29380
IN NAME OF

RICHARD E. and DORIS M. STANFORD

Surveyed JUN. 12 1968, by V. GARNER