

T. 11 S. R. 11 E. W. M.

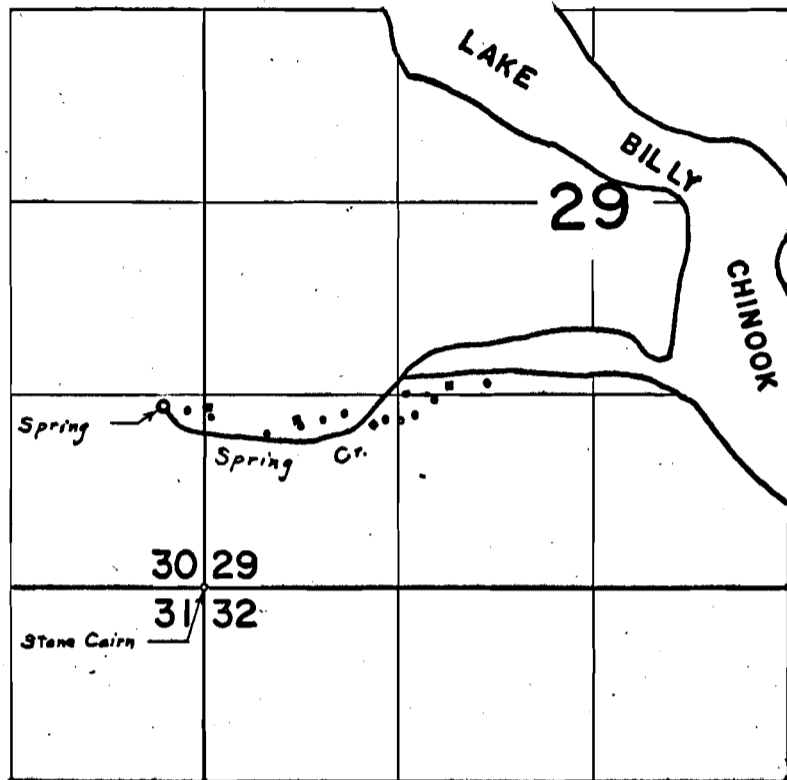

Spring located 1230' N. & 280' W. from S.E. Corner Section 30

Rest Station ■

Water Tap ●

FINAL PROOF SURVEY UNDER

Application No. 39577 Permit No. 29414
IN NAME OF

U. S. D. A., FOREST SERVICE

Surveyed July 13, 1967., by L. E. Gould.....

P# 29414