

T.8S. R.6.W.W.M.

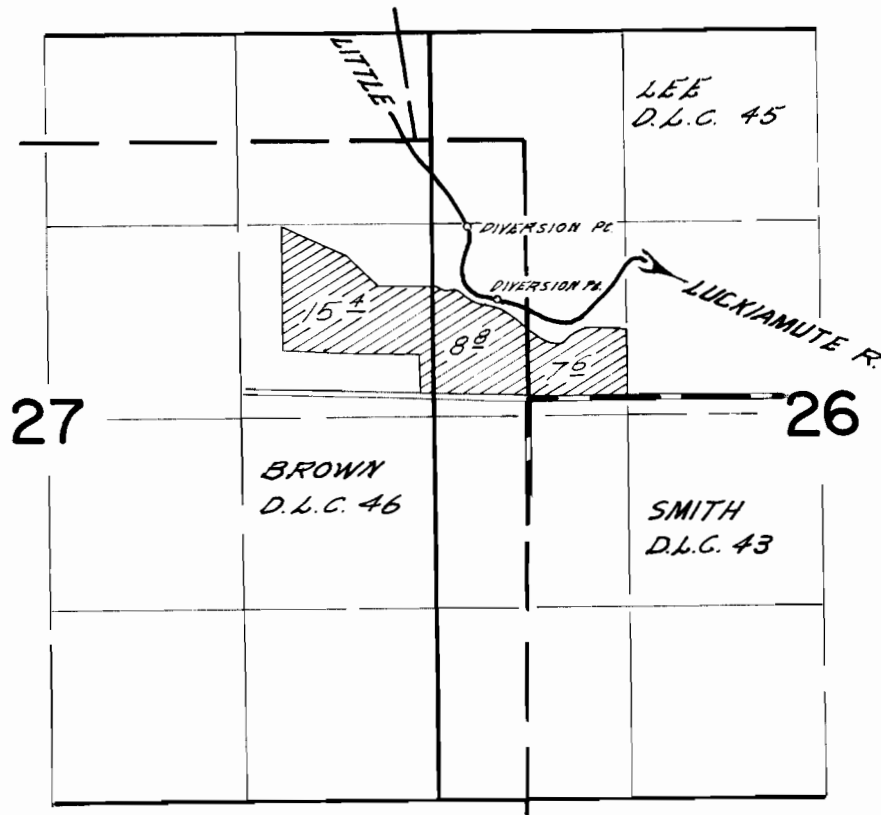

DIVERSION POINTS LOCATED 1180 FT. N. & 400 FT. W.; 670 FT. N. & 200 FT. W. FROM N.W. CORNER SMITH D.L.C. 43

FINAL PROOF SURVEY UNDER

Application No. 42058 Permit No. 31338
IN NAME OF

CORNIE RYAN

Surveyed Feb 25 1968, by *W. J. Ruppert*