

T.3&4S. R.38 & 39E. W.M.

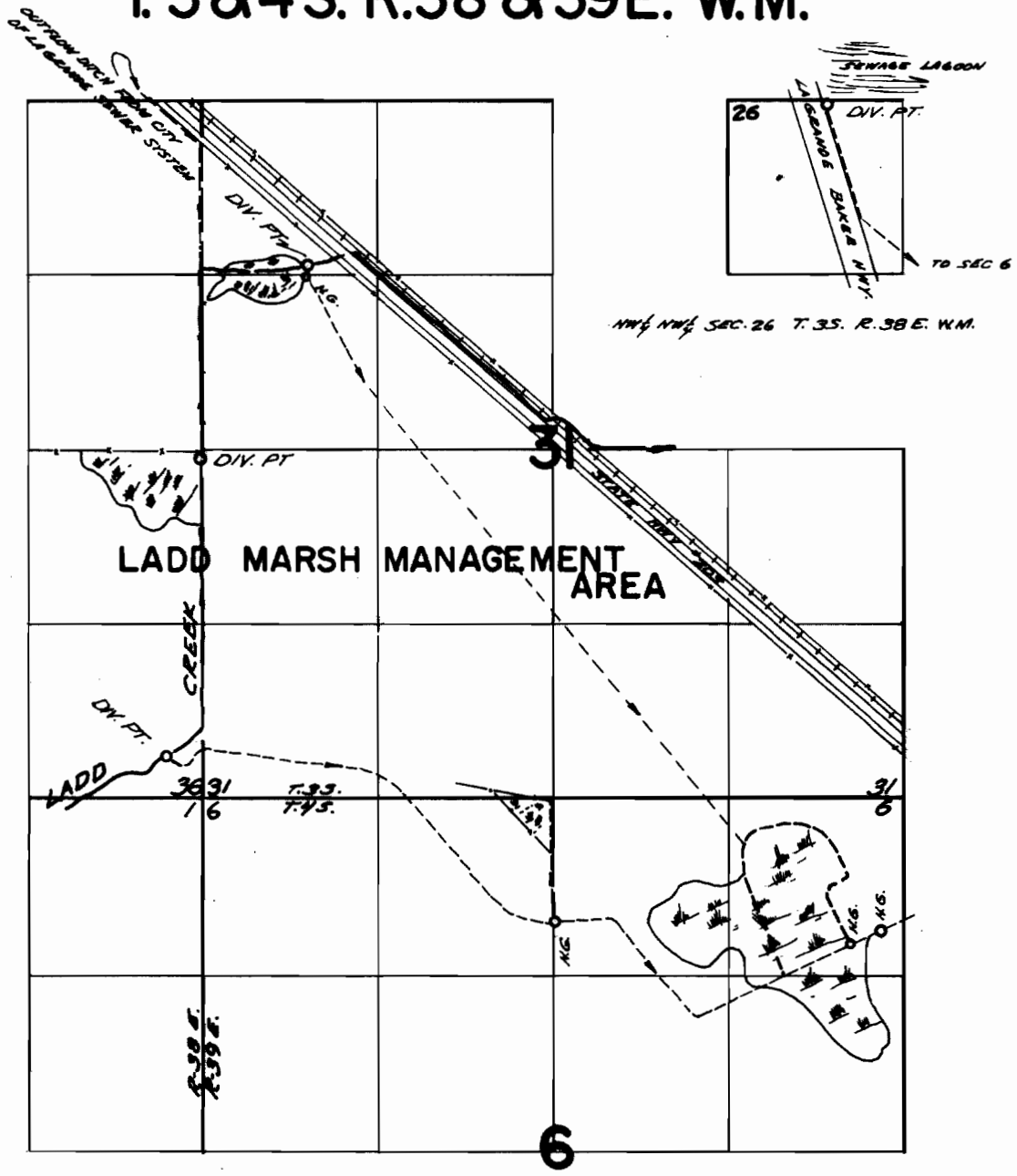

DIV. PTS. LOCATED:- 40 FT.S. & 740 FT. E. FROM THE N.W. COR. SEC. 26;
 1390 FT. N. & 790 FT. E.; 60 FT.S. & 10 FT. W. BOTH FROM THE W &
 COR. SEC. 31; 320 FT. N. & 280 FT. W FROM THE SE COR. SEC. 36

FINAL PROOF SURVEY UNDER

37108 27849
 Application No. 40421 Permit No. 30208
 IN NAME OF

OREGON STATE GAME COMMISSION

Surveyed Aug 27 1968, by V. Garner