

T.38S. R.10E. W.M.

Swan Lake wells

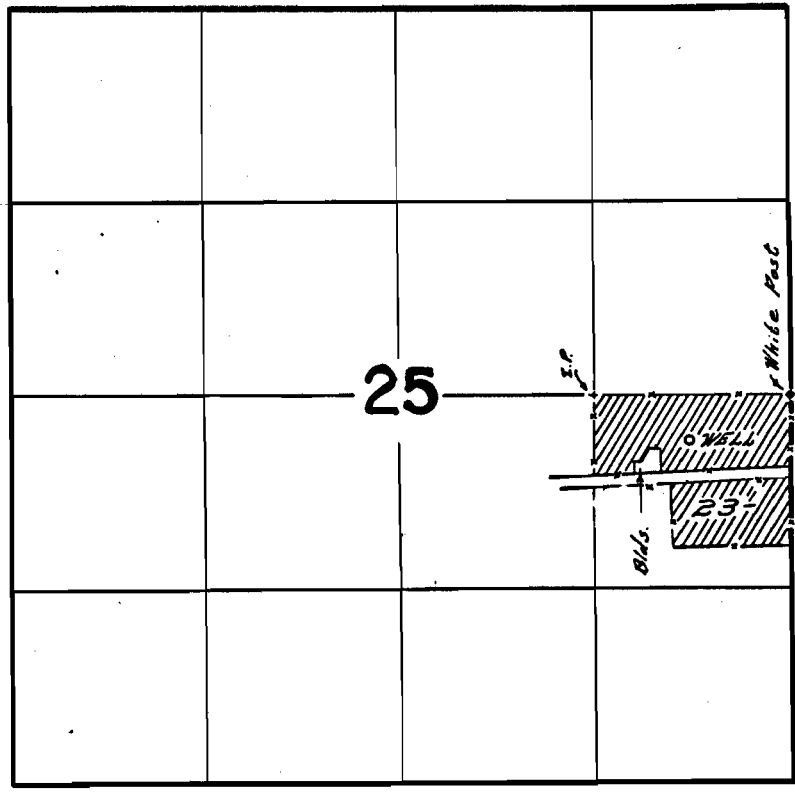

WELL LOCATED 310 FT. S. & 680 FT. W. FROM E 1/4 CORNER SECTION 25

FINAL PROOF SURVEY UNDER

Application No. G-3262 Permit No. G-3060
IN NAME OF

VERN A. DEYARMIE

Surveyed June 2, 1969, by W.J. Support