

T.2N. R.3W. W.M.

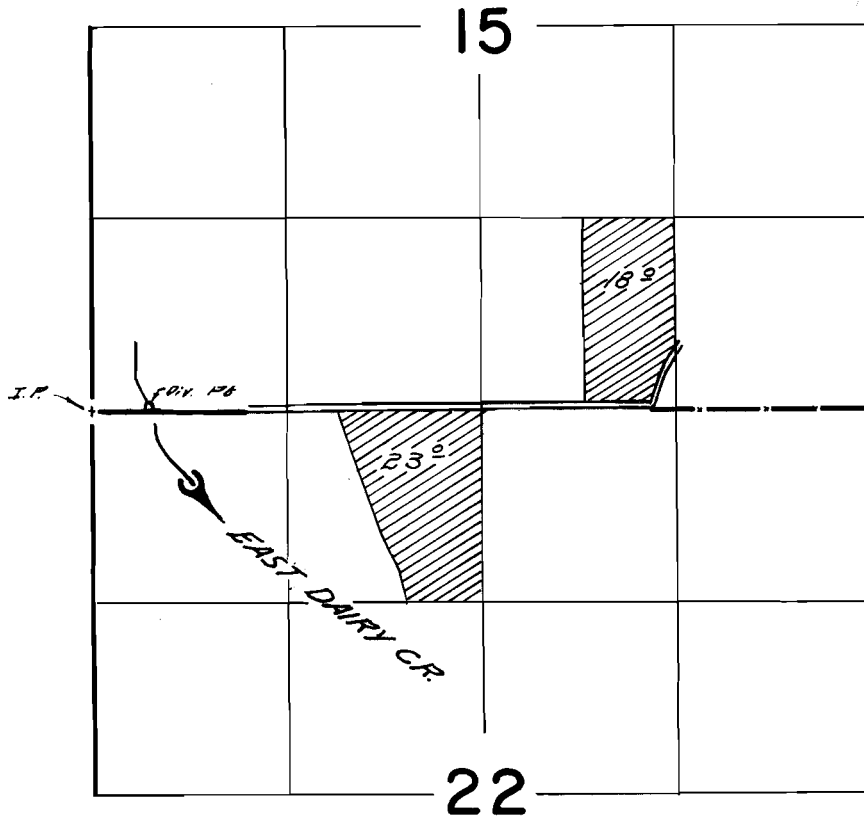

Diversion point located 30 ft. N & 390 ft. E from S.W. cor. Sec 15

**FINAL PROOF SURVEY**  
UNDER

Application No. 40263 Permit No. 30018  
IN NAME OF

MARTIN STADLEMAN

Surveyed Oct. 11, 1968, by W. J. Support