

14

28627
28627
36515

T.34S. R.8.&9E. W.M.

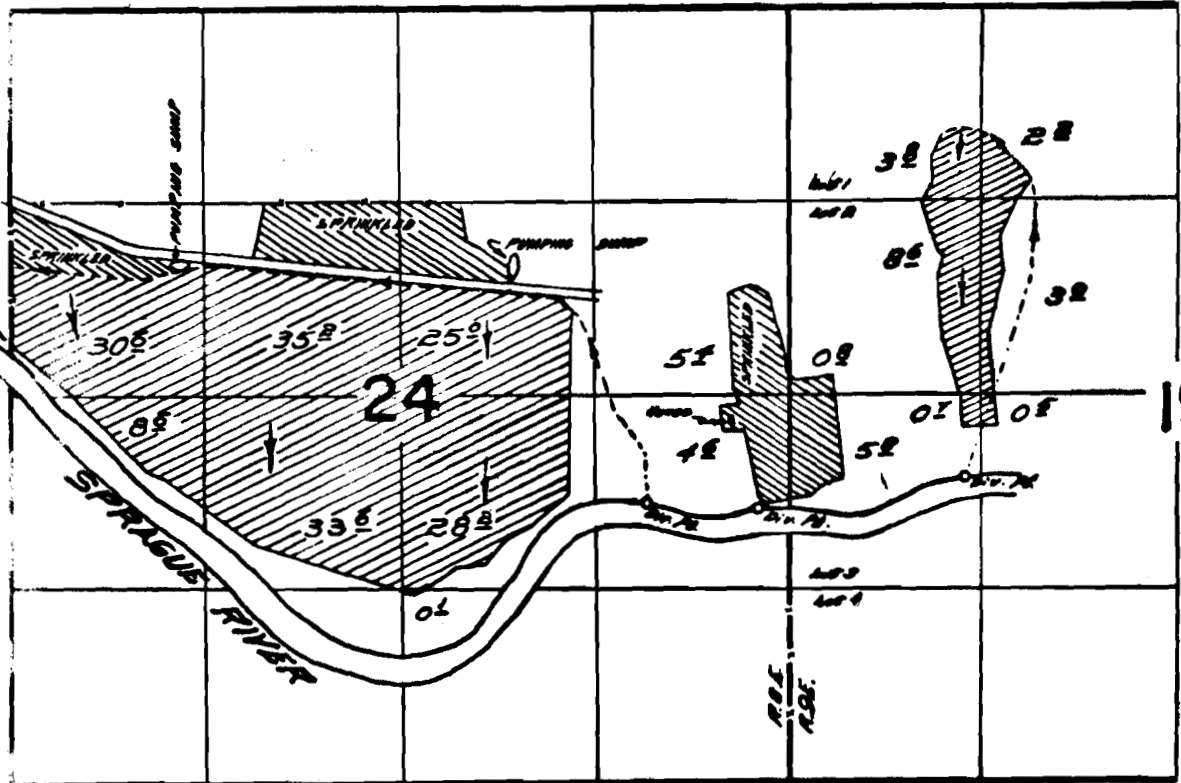

Sprague River

MEASUREMENTS LOCATED 2060 N.S. & 4300 N.E., 2090 N.S. & 5060 N.E., 4000 N.S. & 6160 N.E.
ALL FROM NW CORNER SW 1/4 NW 1/4 SECTION 24.

FINAL PROOF SURVEY UNDER

Priority Date
7/5/62
4.92 c.f.s

Application No. 37780.. Permit No. ~~28627~~
IN NAME OF

FLOYD W. & JESSIE L. HESCOCK

Surveyed April 24, 1968, by *[Signature]*