

# T1N. R. 4W. V1M.

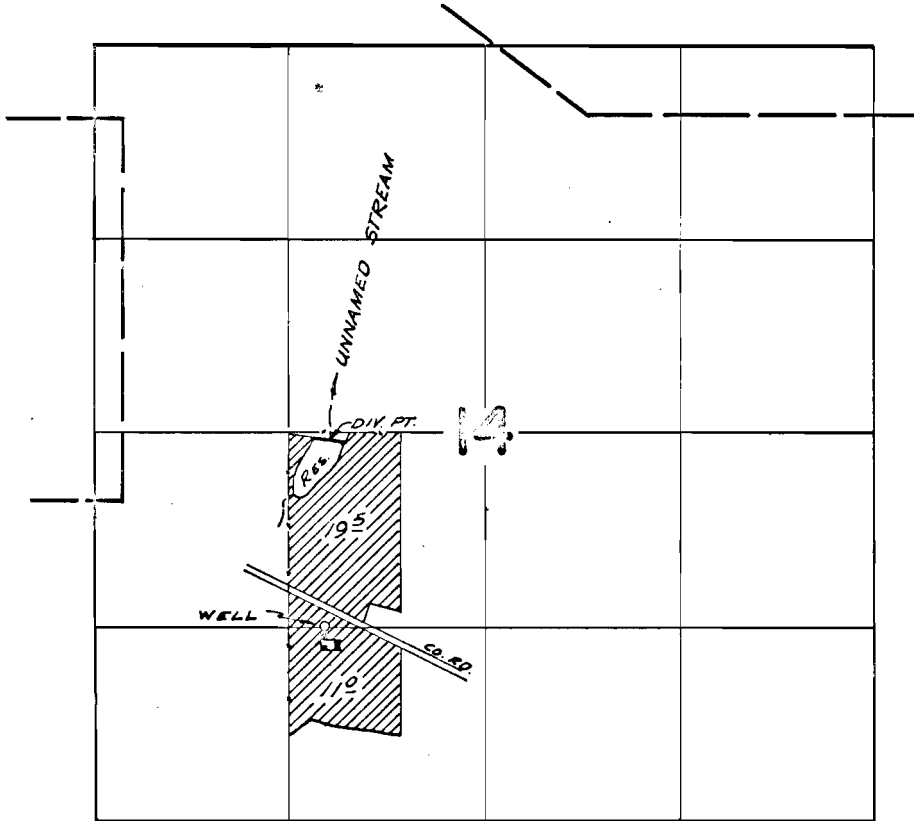

DIV. PT. LOCATED 280 FT. E & 50 FT. S; WELL LOCATED 1320 FT. S & 240 FT. E.; BOTH FROM THE NW CORNER NE  $\frac{1}{4}$  SW  $\frac{1}{4}$  OF SECTION 14.

## FINAL PROOF SURVEY

UNDER

R-39139

39140

R-41450

41716

R-44064

44065

R-3876

29183

R-4669

30964

R-5080

32027

Application No. G-4079 Permit No. G-3833

IN NAME OF

JOE HEESACKER

Surveyed June 28 1968, by V. Garner