

T1N. R. 4W. V. 1M.

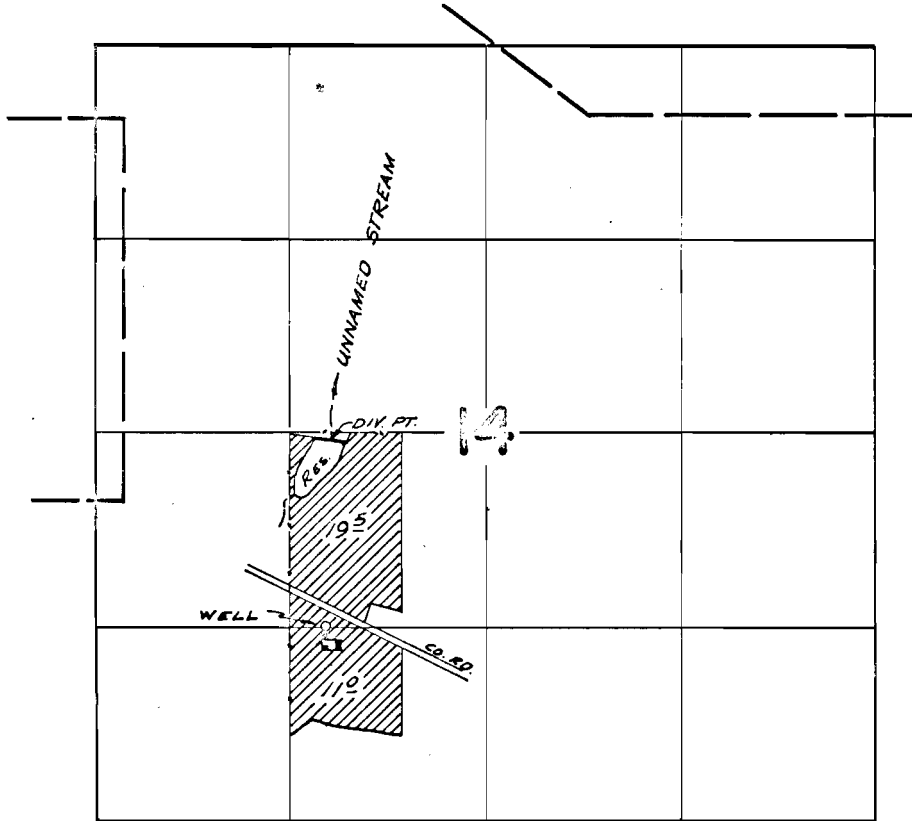

DIV. PT. LOCATED 280 FT. E & 50 FT. S; WELL LOCATED 1320 FT. S & 240 FT. E.; BOTH FROM THE NW CORNER NE $\frac{1}{4}$ SW $\frac{1}{4}$ OF SECTION 14.

FINAL PROOF SURVEY

UNDER

R-39139
39140
R-41450
41716
R-44064
44065

R-3876
29183
R-4669
30964
R-5080
32027

Application No. G-4079 Permit No. G-3833

IN NAME OF

JOE HEESACKER

Surveyed June 28 1968, by V. Garner