

MAP OF PROPOSED TROUT CREEK DITCH

UNION AND BAKER COUNTY
OREGON.

SCALE 2 IN. = 1 MI.

JULY, 6, 1930.
ROSCOE NEAL, COUNTY SURVEYOR
UNION COUNTY, OREGON.

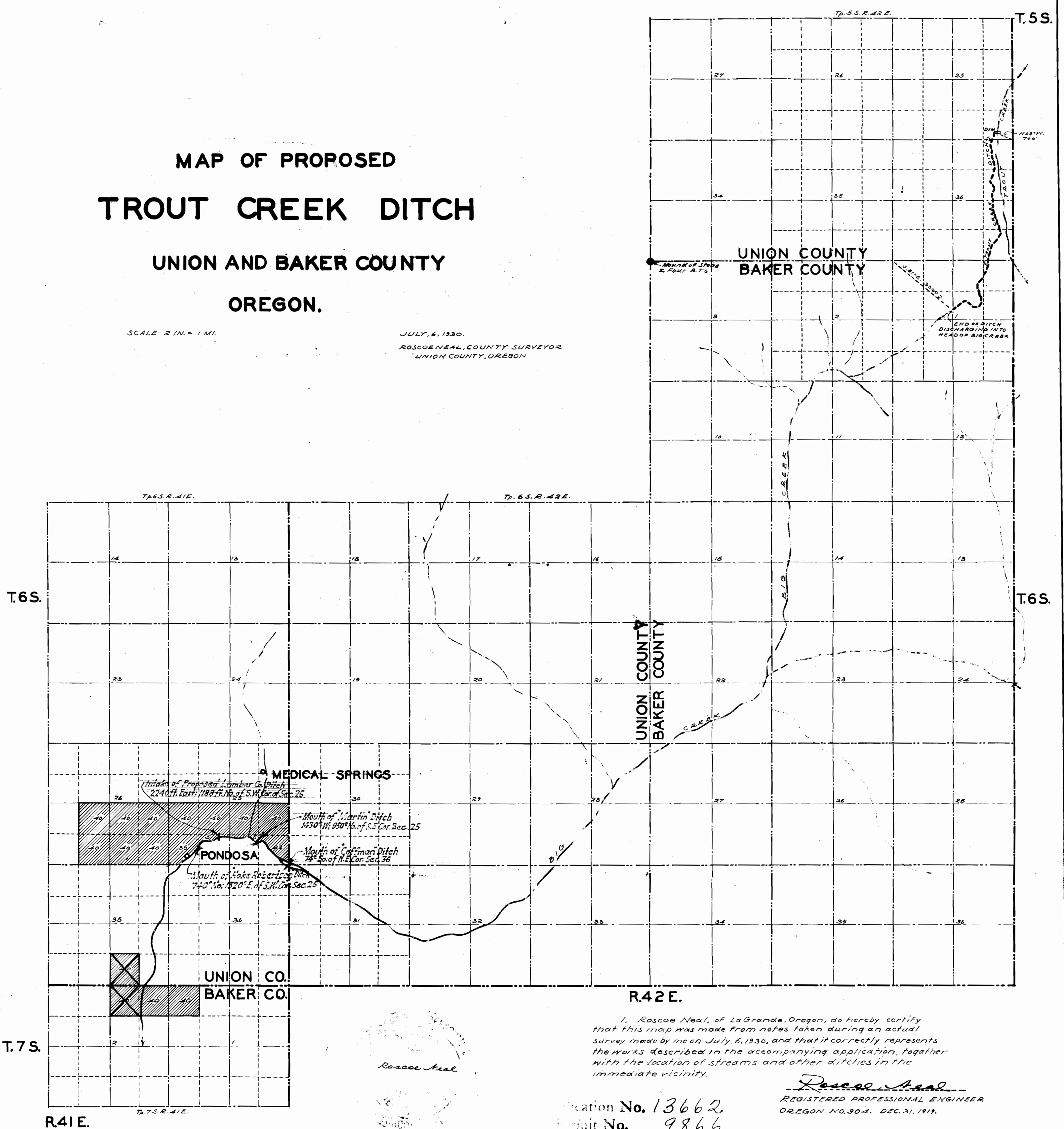

I, Roscoe Neal, of La Grande, Oregon, do hereby certify that this map was made from notes taken during an actual survey made by me on July, 6, 1930, and that it correctly represents the works described in the accompanying application, together with the location of streams and other ditches in the immediate vicinity.

Roscoe Neal
COUNTY SURVEYOR
UNION COUNTY, OREGON

Roscoe Neal
REGISTERED PROFESSIONAL ENGINEER
OREGON NO. 904. DEC. 31, 1919.

Application No. 13662
Permit No. 9866