

P-28768
36584
34890

T.13S.R29E. W.M.

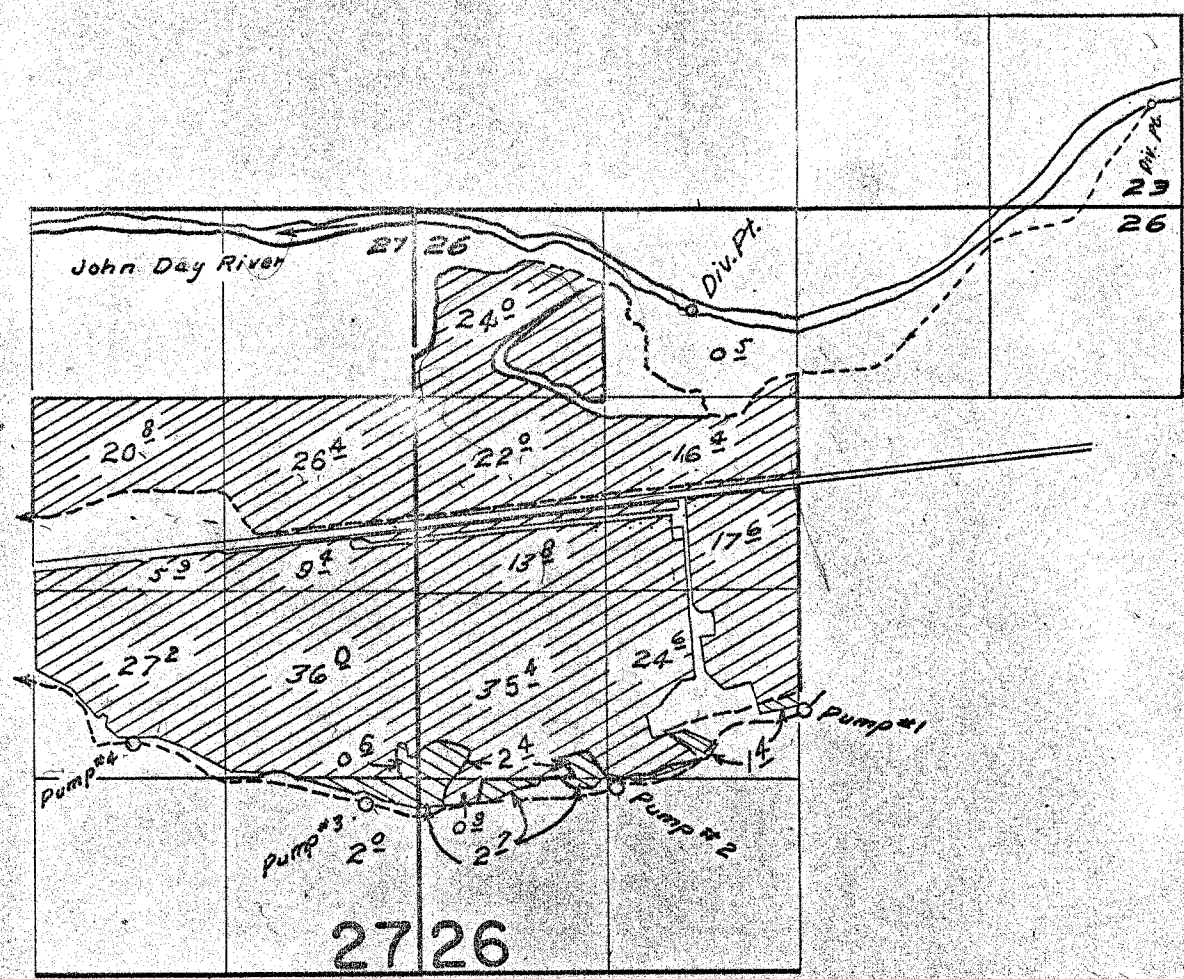

 Supplemental
 Primary

*Diversion points located 690 f.S. & 3260 S.W. &
 710 f.S. N. & 200 f.S. N. from N.E. Cor. Sec. 26*

FINAL PROOF SURVEY UNDER

Application No. 38657... Permit No. 28768...
 IN NAME OF

John E. McCaige

Surveyed Oct. 26, 1964, by R. Jackson...
 June 21, 1967 by W.J. Ruppert.